

FUJIFILM

instax mini Evo Cinema™

HYBRID INSTANT CAMERA

User's Guide (Full version)

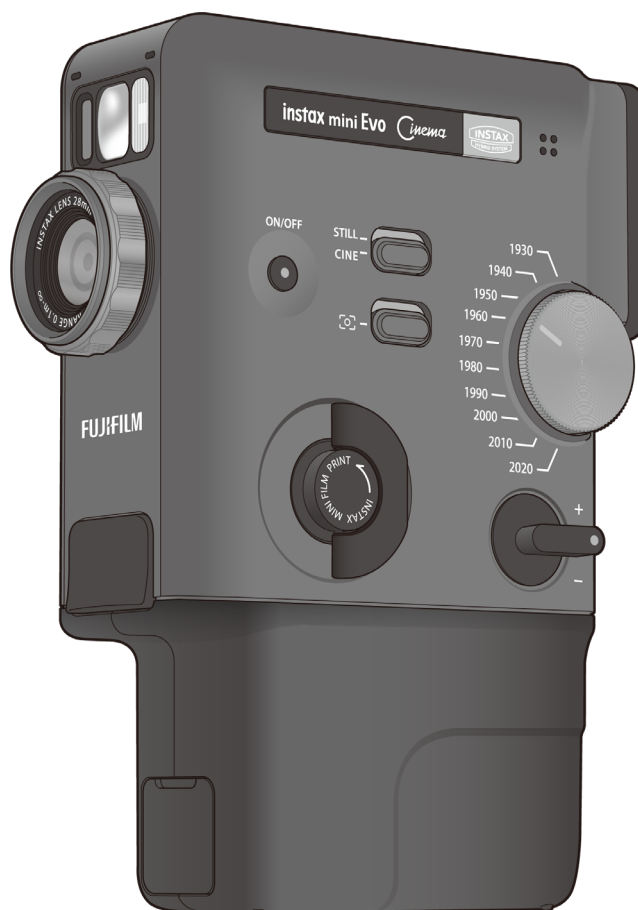

- Depending on the firmware version, the camera's functions and screens may differ from those described.
- There are two methods to upgrade the firmware. For details, refer to 'Upgrading the Firmware' (p. 41)

Table of Contents

Preparation for the Camera	4	Using the Self-Timer to Take Photos (Still Image) ...	28
Before Use	4	Taking Photos with the Flash (Still Image)	28
Attaching the Hand Strap	5	Setting the White Balance (Still Image)	29
Attaching the Viewfinder Attachment	6	Make Focusing Easier (Still Image)	29
Attaching the Grip Attachment	6	Playback	30
Part Names	7	Viewing Videos	30
LCD Screen Display	8	Viewing Still Images	30
Using the Select Button/Command Dial	10	Adjust the Volume of a Video	31
Using a Memory Card	10	Deleting Videos/Still Images	32
Inserting a Memory Card	11	Single-frame Display	32
Removing a Memory Card	11	4-frame Display	32
Charging the Battery	12	Deleting All Videos/Still Images	33
Charging Status Indication When the Camera is		Viewing Shooting Information	33
Turned Off	12	Printing from Videos	34
Loading the instax™ mini Film Cartridge	13	Printing Still Images	35
Unloading the instax™ mini Film Cartridge	14	Film Remaining Display	36
Power On/Off	14	Set the Image Quality and Brightness before	
How to Check the Battery Level	14	Printing	36
Setting up the Language and Date/Time	15	Selecting Print Quality	36
Pairing Settings	16	Adjusting the Brightness of an Image to be	
Shooting	18	Printed	37
About Shooting	18	Captured Data	38
Notes on the Shooting	18	Where Shooting Data is Saved	38
Video Recording	19	When a Memory Card is not Inserted	38
Saving the Video via the Direct Menu	20	When a Memory Card is Inserted	38
Change the Shutter Operation Method While		Number of Saved Videos/Still Images	38
Shooting	21	Setting Menu	39
Shooting in High-quality Mode	21	Operations and Options in the Setting Menu	39
Taking Still Images	22	Items in the Setting Menu	39
Using AF/AE Lock to Take Photos	23	Overview of the App	42
Viewing Recording Information	24	Smartphone App Linked Functions	42
Eras Dial™ Effect	25	Installing the Smartphone App	42
Preview Eras Dial™ Effects	25	Other Information	43
Various Shooting — Direct Menu	26	Specifications	43
Displaying the Direct Menu	26	Troubleshooting	44
Adjusting the Brightness (Video/Still Image)	26	Notes on Disposing of the Camera	46
Adjusting the Volume of Sound Effects (Video)	27	Removing the Battery	46
Using the Video Light (Video)	27	Installing a Battery	46
		IMPORTANT SAFETY NOTICE	47

Simple Camera Care47

Wireless LAN / Bluetooth® Devices: Cautions48

Note when handling the instax™ mini instant film cartridge

Do not open the film door until you have used up all of the film; otherwise, the rest of the film is exposed and turns white. The film can no longer be used.

Preparation for the Camera

Before Use

Before using the camera, check you have the following:

Supplied Accessories

- USB Type-C cable (BO38A34001) (1)
- Hand strap (1)
- Viewfinder Attachment [with a strap] (1)

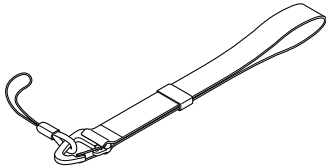

- Viewfinder Attachment [with a strap] (1)

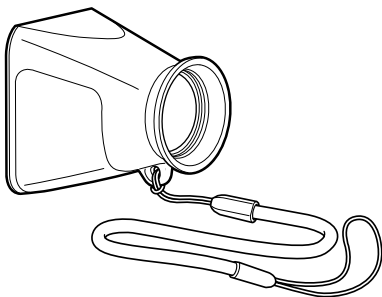

- Grip Attachment (1)

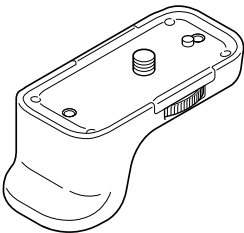

- User's Guide (1)

- Use the strap over your wrist, not around your neck.
- Make sure the hand strap does not hang over the Film Ejection Slot.
- ❗ The battery has not been fully charged at the factory, be sure to charge the battery before using the camera.
- ❗ Dedicated USB Type-C cable is supplied to charge the camera.
- ❗ The camera incorporates a safety feature that automatically switches the camera off if the internal temperature exceeds the safe operating range. This prevents damage to the camera and avoids safety risks. To resume use, ensure the camera has cooled sufficiently before switching it back on.

Read 'IMPORTANT SAFETY NOTICE' (p. 47) for safety information.

Preparation for the Camera

Attaching the Hand Strap

Follow the steps below to attach the hand strap to the camera body.

- 1** Remove the short and long straps from the hand strap.
- 2** Thread the short strap through the camera's Strap Eyelets.

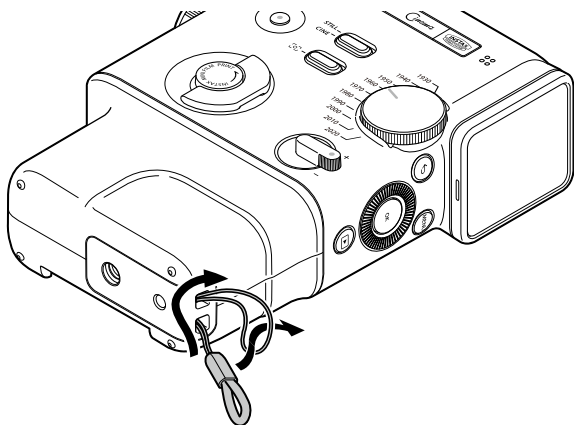

- 3** Attach the short strap to the carabiner on the hand strap.

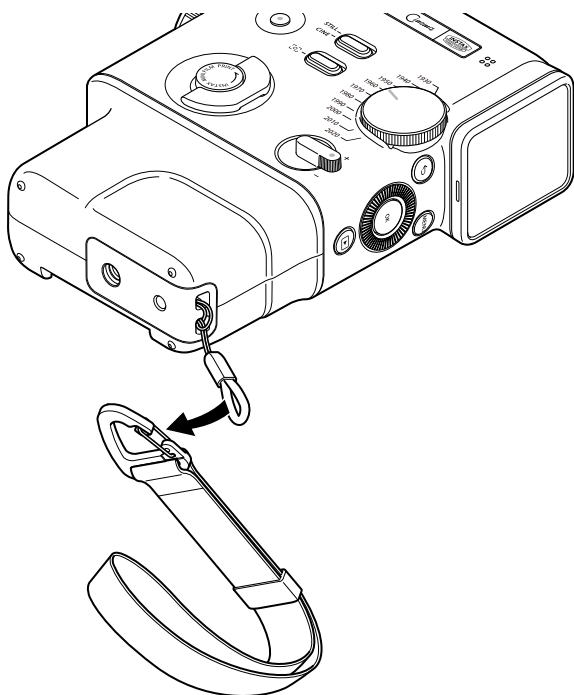

- 4** Slip the hand strap over your wrist and adjust it using the adjuster.

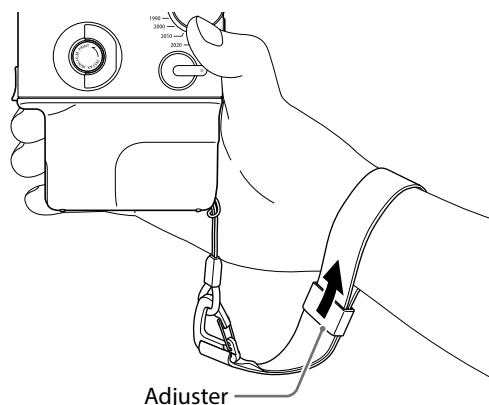

- Tighten the adjuster to prevent the camera from falling.

Preparation for the Camera

Attaching the Viewfinder Attachment

Follow these steps to attach the Viewfinder Attachment to the camera body. Attaching it in front of the LCD Screen enables you to shoot through the viewfinder.

- 1 Remove the long strap from the hand strap and thread it through the hook on the Viewfinder Attachment.

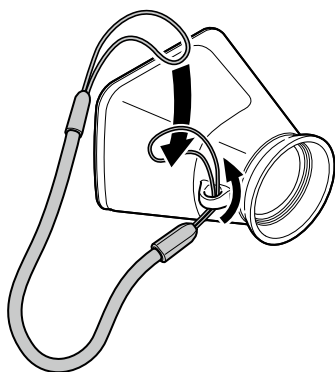

- 2 Thread the long strap through the carabiner.

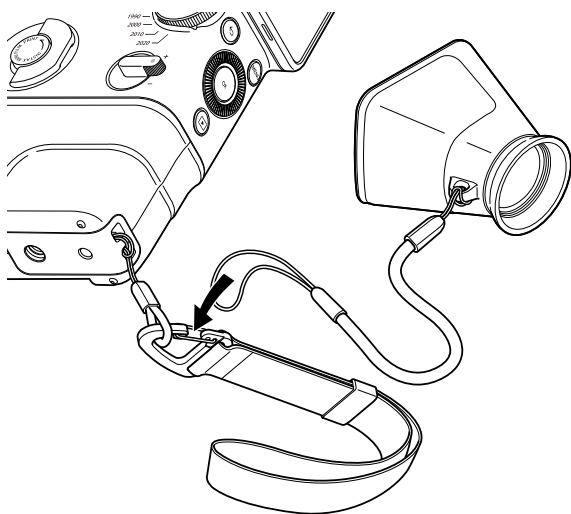

- 3 Attach the Viewfinder Attachment by placing it over the hand strap at an angle.

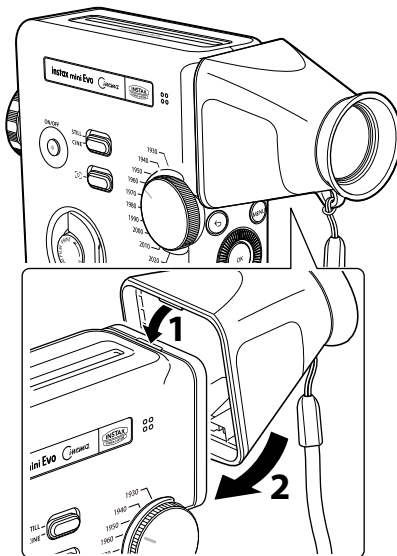

- Make sure that the protrusion at the top of the Viewfinder Attachment aligns with the groove at the top of the LCD Screen.

Attaching the Grip Attachment

Attaching the Grip Attachment makes the camera easier to hold. Secure it by rotating the dial to lock it in place.

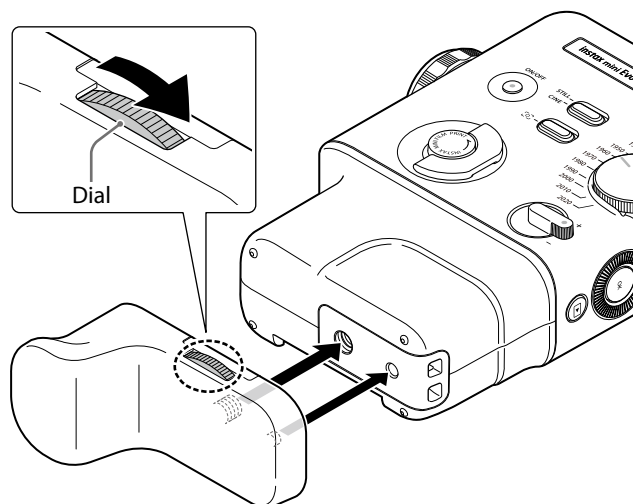

Preparation for the Camera

Part Names

Front

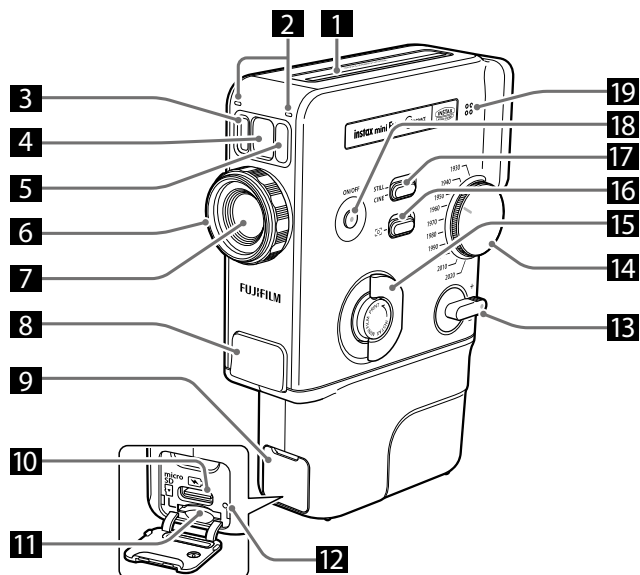

Rear

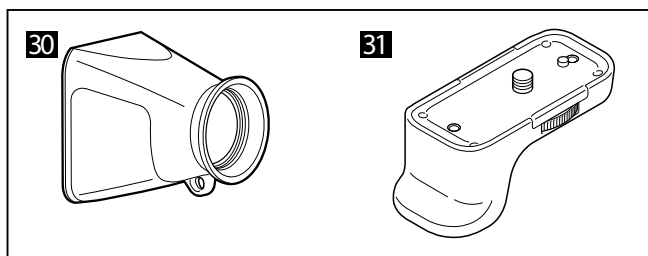
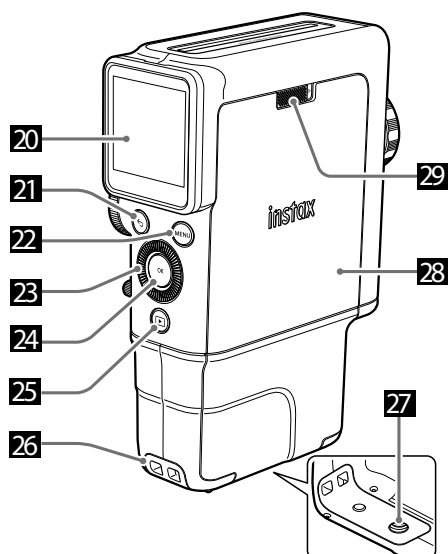

- 1** Film Ejection Slot
- 2** Microphone
- 3** Recording Light/Charging Lamp/Self-timer Lamp
Lights up or blinks according to the setting. It is lit when recording videos and blinks when using the Self-timer. It also lights up while charging and turns off when charging is complete.
- 4** Selfie Mirror
Use the Selfie Mirror to check the composition of your photo, and ensure you are in the shot.
- 5** Flash
The Flash operates depending on the setting.
- 6** Degree Control Dial
Adjusts the degree of the Eras Dial™ effect.
- 7** Lens
- 8** Shutter Button
Compose the picture and press the Shutter Button halfway down to focus. After confirming that the camera is in focus, press the Shutter Button all the way down to take a picture.
- 9** Cover for USB Type-C Port & Micro SD Card Slot
- 10** USB Type-C Port
This is the USB port for charging the camera. The USB Type-C Port cannot be used for data transfer.
- 11** Micro SD Card Slot
- 12** Reset Button
If the camera is not operating properly, press this button to force the camera to turn off. Do not use the Reset Button while the camera is operating normally. Doing so may cause the photo data to be erased.
- 13** Zoom Lever
Tilt it towards + to zoom in and towards – to zoom out.
- 14** Eras Dial™
Cycles through ten Eras Dial™ effects.
- 15** Print Lever
Lift the lever and rotate it 90 degrees counterclockwise to print.
- 16** Frame Switch
Turns on/off the frame for the selected Eras Dial™ effect.
- 17** CINE/STILL Mode Switch
Switches between video (CINE) and still image (STILL) mode when shooting.
- 18** Power Button
Press and hold the Power button for approximately 1 second to turn the camera on or off.
If the camera is left idle for a short period of time, it will automatically shut down. To turn it back on, switch the power off and then on again.
- 19** Speaker

Preparation for the Camera

20 LCD Screen

21 Back Button

22 MENU Button

23 Select Button/Command Dial

24 OK Button

25 Playback Button

Playback videos/still images on the LCD Screen. Press the Shutter Button all the way down to return to the shooting screen.

26 Strap Eyelets

27 Tripod Mount

Grip Attachment (supplied) or a tripod can be attached.

28 Film Door

When loading/unloading a film cartridge, slide the Film Door Lock to unlock the film door and lift it open. Do not open the film door until you have used up all of the film; otherwise, the rest of the film is exposed and turns white. The film can no longer be used.

29 Film Door Lock

30 Viewfinder Attachment (supplied)

When attached to the LCD Screen, it allows you to take pictures as if you were looking through the viewfinder. When attaching, be sure to align the protrusion on the top of the Viewfinder Attachment with the groove on the top of the LCD Screen.

31 Grip Attachment (supplied)

It can be attached to the camera's Tripod Mount to make holding the camera easier. Once attached, rotate the dial to lock it in place.

LCD Screen Display

When the camera is turned on, a live view appears on the LCD Screen. Each time you press the Playback Button, the screen switches between the shooting screen and the playback screen. Pressing the MENU Button displays the **direct menu**.

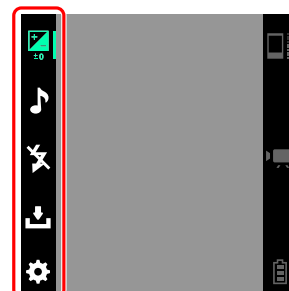
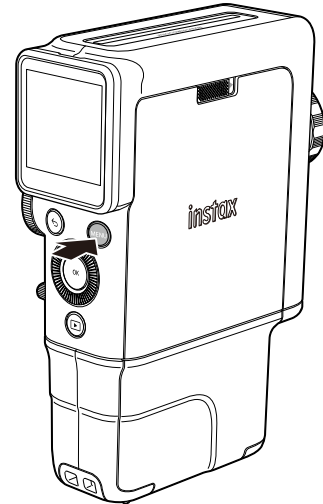

Video recording mode

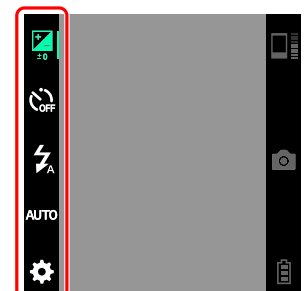

Still image capture mode

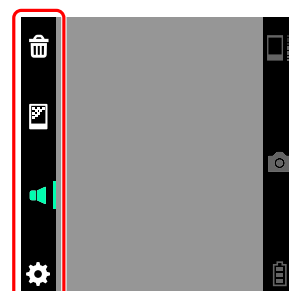

Playback mode

Preparation for the Camera

■ Shooting screen

The subject can be checked on the LCD Screen. This state is called the **shooting mode**.

Use the CINE/STILL Mode Switch to toggle between video recording mode and still image capture mode.

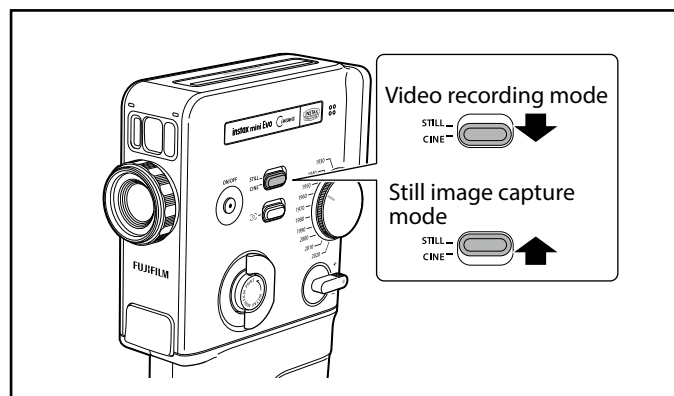

Video recording mode

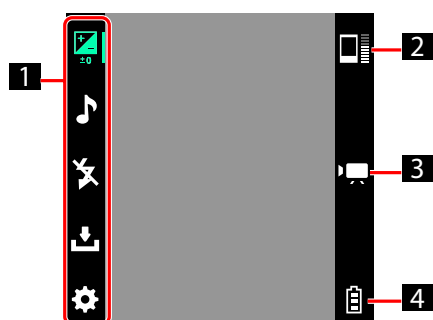

Still image capture mode

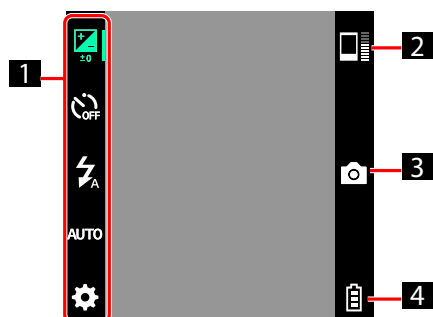

■ Playback screen

When in shooting mode, pressing the Playback Button displays the captured image. This state is called **playback mode**.

Playback mode

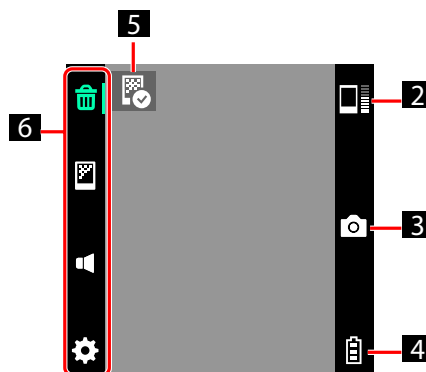

• Operation guide



- 1 Direct menu (in shooting mode)
When the MENU Button is pressed, it appears on the left side of the LCD Screen. You can set the self-timer, flash, brightness adjustment, and other shooting settings.
- 2 Prints remaining in the cartridge
- 3 Shooting (video/still image) mode indication
- 4 Battery level
- 5 Previously printed mark
This mark appears on previously printed images.
- 6 Direct menu (in playback mode)
When the MENU Button is pressed, it appears on the left side of the LCD Screen. Deleting images, adjusting playback volume can be made during playback.
- 7 Operation guide
A corresponding operation guide will be displayed on the screen.

Preparation for the Camera

Using the Select Button/Command Dial

The Select Button/Command Dial allows you to select menu items and navigate through options. The Select Button is operated by pressing the up, down, left, and right buttons, while the Command Dial is operated by turning the dial.

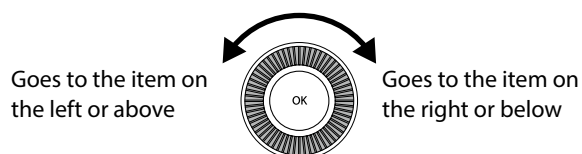
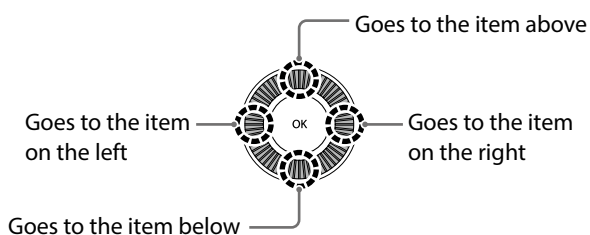
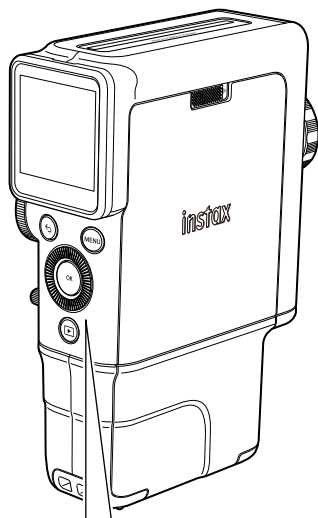

For exposure and volume settings, turn clockwise to adjust towards the positive side and counterclockwise towards the negative side.

Press the OK Button to confirm your selection.

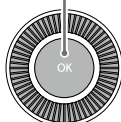

Using a Memory Card

The camera's internal memory can store about 10 videos (STANDARD mode. High-quality video mode cannot be stored) and about 50 still images, but you can store more images by using a memory card.

Precautions Regarding Memory Cards

- This camera is compatible with microSD memory cards, microSDHC memory cards and microSDXC memory cards (up to 256 GB). Using other types of memory cards may cause damage to the camera.
- Memory cards are small and may be accidentally swallowed by infants. Keep them out of the reach of infants. In the unlikely event that an infant swallows a memory card, consult a physician immediately.
- **Do not turn off the camera or remove the memory card during formatting or while recording/deleting data. The memory card may become damaged.**
- Do not use or store memory cards in an environment that is prone to strong static electricity or electrical noise.
- Inserting a memory card charged with static electricity into the camera may cause the camera to malfunction. If this happens, turn the camera off and then on again.
- Do not carry a memory card in the pocket of your pants. A strong force may be applied when you sit down, which may cause the memory card to break.
- The memory card may become hot to the touch after prolonged use, but this is not a fault.
- Do not put any labels on memory cards. If the label comes off, it may cause the camera to malfunction.

Precautions When Using a Memory Card on a PC

- Always format an unused memory card or a memory card that has been used on a PC or other device before using it in the camera.
- When a memory card is formatted in the camera and used for shooting and recording, folders are automatically created. Do not use your PC to rename or delete folders or files on the memory card. Doing so may make the memory card in the camera unusable.
- Do not use your PC to delete videos/still images on the memory card. Always use the camera.
- If you want to edit a video/still image file, copy or move the video/still image file to a hard disk or similar device, and then edit the copied or moved file.

Preparation for the Camera

Inserting a Memory Card

- 1 Open the Card Slot Cover.

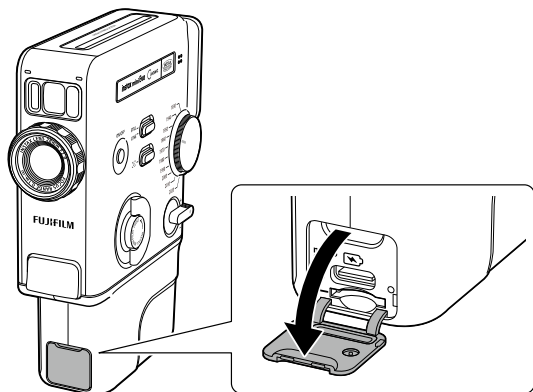

- 2 Insert the memory card all the way in the correct orientation as shown until you hear a “click”.

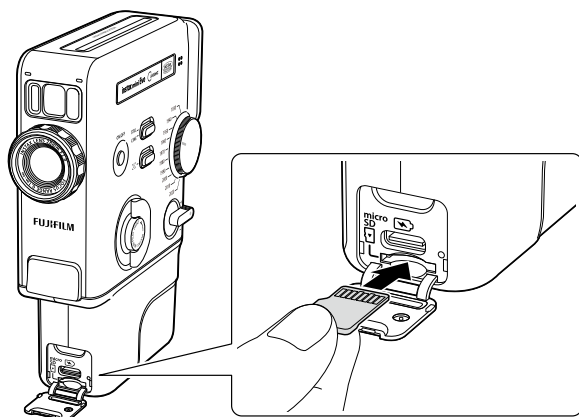

- 3 Close the Card Slot Cover.

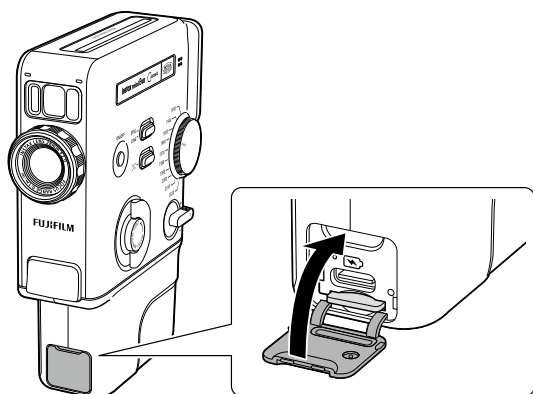

Removing a Memory Card

To remove a memory card, press down on it with your finger, then gently release the pressure on the card to eject from the Card Slot.

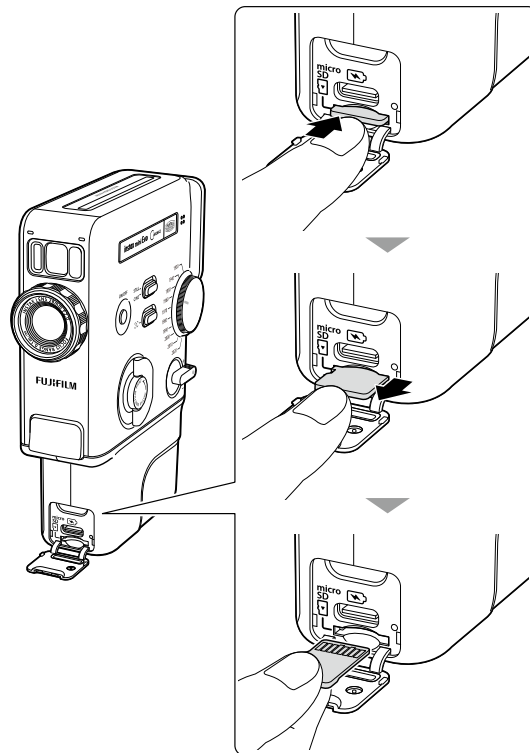

- To remove the memory card, press it in with your finger and slowly pull it out. This releases the lock, allowing you to take it out.

If you suddenly release your finger while removing the memory card, the card may pop out. Release your finger gently.

Preparation for the Camera

Charging the Battery

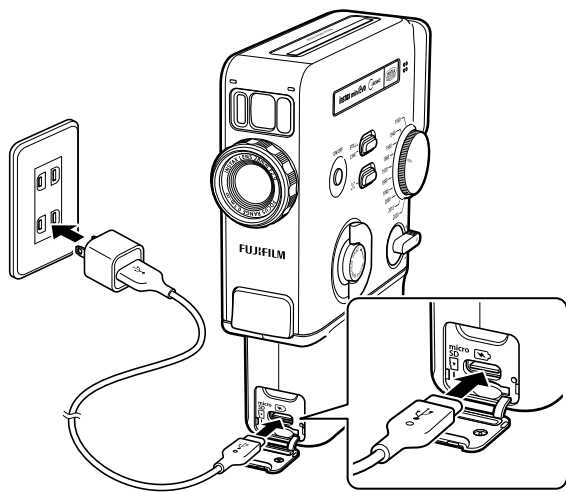

Connect the camera using the supplied USB Type-C cable to a USB AC adapter, then connect the USB AC adapter (not included) to an indoor power outlet.

- Charging time is approximately 2 to 3 hours.
- The power delivered by the charger must be between min 2.5 Watts required by the radio equipment, and max 5 Watts in order to achieve the maximum charging speed.

Charging Status Indication When the Camera is Turned Off

While charging	Charging lamp lights up.
Charging finished	Charging lamp turns off.
Charging error	Charging lamp flashes.

Charging from a PC:

- Connect the camera and PC directly. Do not connect via a USB hub or keyboard.
- If the PC goes into sleep mode while charging, charging is paused. To continue charging, exit sleep mode and then reconnect the USB Type-C cable.
- The battery may not be able to charge depending on the specifications, settings or conditions of the PC.
- Dedicated USB Type-C cable supplied to charge the camera.

Notes

- The battery is not fully charged at the factory, be sure to charge the battery before using the camera.
- For notes about the battery, see 'Simple Camera Care' (p. 47)

Preparation for the Camera

Loading the instax™ mini Film Cartridge

Caution

Do not open the film door until you have used up the film; otherwise, the rest of the film will become exposed and turn white, then the film can no longer be used.

- When you load the film cartridge, never press the two rectangular holes on the back of the film cartridge.
- Never use a film cartridge beyond its shelf life; otherwise, it may damage the camera.

Use FUJIFILM instax™ mini instant film only. instax™ SQUARE film and instax™ WIDE film cannot be used.

Notes on the film cartridge

- Each FUJIFILM instax™ mini film cartridge contains a black protective cover and 10 film sheets.
- Do not remove the film cartridge from its inner foil packaging until you are ready to load the film into the camera.
- The protective film cover is ejected automatically when the Film Door is closed.

For details, refer to the instructions and warnings on FUJIFILM instax™ mini instant film packaging.

- 1 Slide & hold the Film Door Lock in place, then open the Film Door.

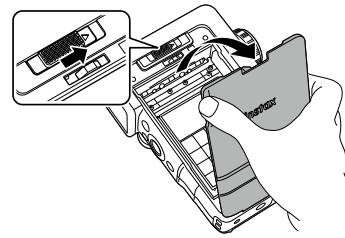

- 2 Insert a film cartridge by aligning the yellow marks on the film cartridge and the body of the camera.

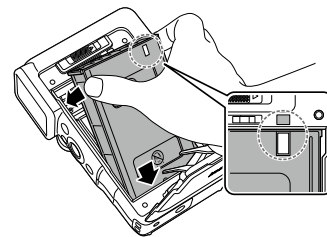

- 3 Close the Film Door. Push the Film Door in until it locks.

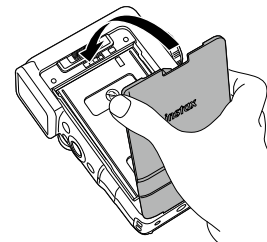

- 4 A black protective cover will be automatically ejected. Remove and dispose.

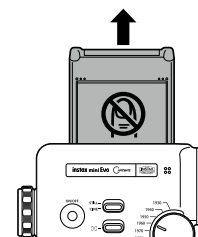

Preparation for the Camera

Unloading the instax™ mini Film Cartridge

Caution:
Do not open the film door until you have used up all of the film; otherwise, the rest of the film is exposed and turns white. The film can no longer be used. You can check the number of remaining films on the LCD Screen.

- 1 Check to see if you have film remaining. If the LCD Screen shows '0/10' it is time to replace the Film Cartridge.

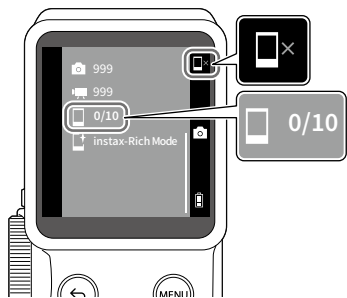

- 2 Slide & hold the Film Door Lock in place, then open the Film Door.

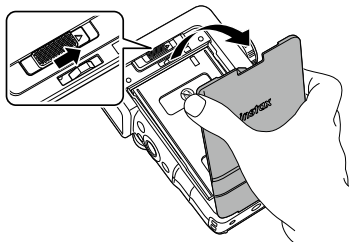

- 3 Grip the rectangular holes on the empty Film Cartridge and remove from the camera.

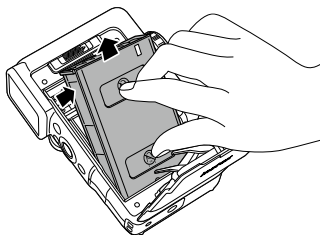

Power On/Off

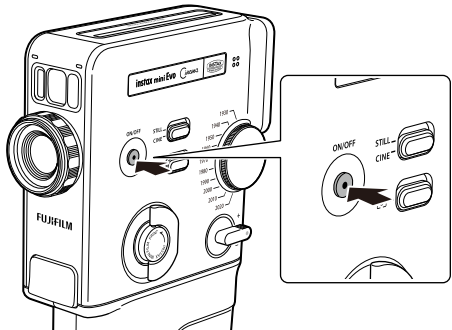

Press and hold the Power Button for approximately 1 second to turn the camera on or off.



- If you do not operate the camera for a certain period of time, it will automatically turn off. If the camera turns off automatically, turn the power off and then on again to turn it on.

How to Check the Battery Level

The battery level is displayed on the lower-right corner of the LCD Screen.

Display	Remaining battery charge
	Sufficient battery charge remaining.
	Less than half of battery charge remaining. Recharging the battery is recommended.
	Low battery. Please recharge the battery as soon as possible.

- When the battery is depleted, an icon  will appear in the middle of the LCD Screen and the power will turn off.

Preparation for the Camera

Setting up the Language and Date/Time

When you turn on the camera for the first time after purchase, you will be prompted to set the date & time, along with the language of your choice.

This setting can be configured at a later time. If you want to set or re-set it later, set it from [言語/LANG.] and [DATE/TIME] in the SETTINGS menu.

- 1 Turning on the power.
 - When you turn on the camera for the first time after purchase, the language setting screen will appear.

- 2 Select the language you want to use.



- 3 Set the year, month, and day in that order.

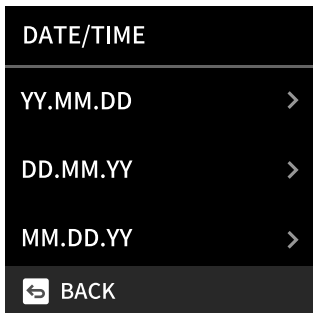

- 4 Set the year, month, and day.

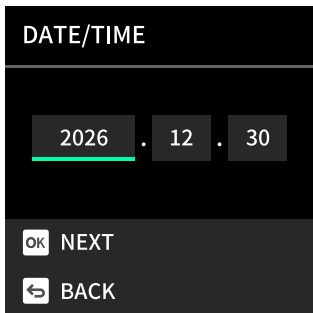

- 5 Set the hour and minute.

The language and date/time are now set.

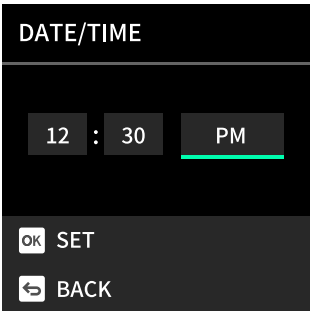

Preparation for the Camera

Pairing Settings

By connecting to the smartphone app "instax mini Evo™", you can enjoy a variety of functions. To connect to the smartphone app, you need to pair the camera with your smartphone.

For details, see 'Smartphone App Linked Functions' (p. 42).

- Make sure your smartphone is ready for Bluetooth communication before you start.

Camera

1 Press the MENU Button on the camera.

The direct menu appears.

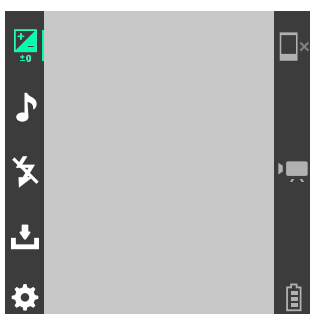

2 Select [⚙️].

The setting menu appears.

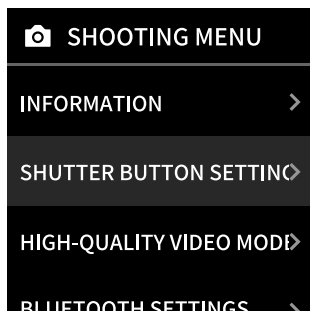

3 Select [BLUETOOTH SETTINGS].

The setting menu appears.

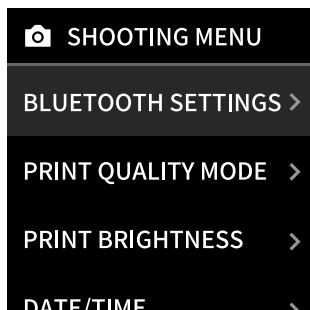

4 Select [PAIRING REGISTRATION].

The PAIRING REGISTRATION menu appears.

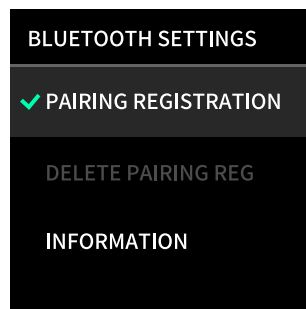

Smartphone

5 Open the smartphone app "instax mini Evo™".

6 Tap on the smartphone app.

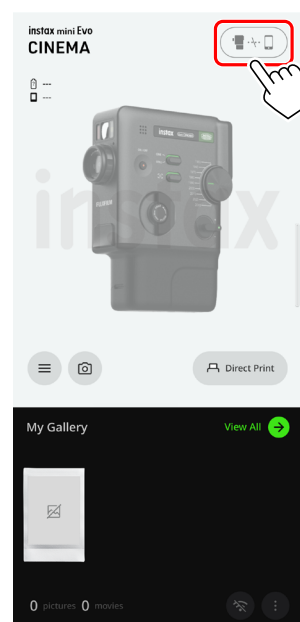

7 Confirm the camera's name on the screen, and tap [Connect] on the smartphone app.

- Android users will be notified of a pairing request. iOS users will be shown a pairing code.

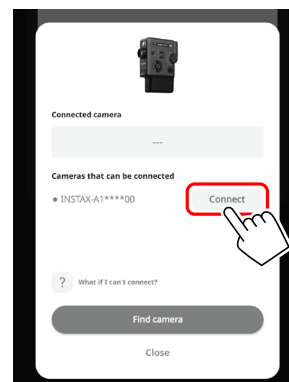

Preparation for the Camera

Camera/Smartphone

- 8** Confirm that the six-digit numbers displayed on the camera and smartphone match, then allow pairing.

- Camera: Press the OK Button.

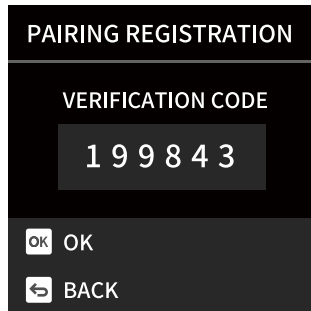

- Smartphone: Tap [PAIR].

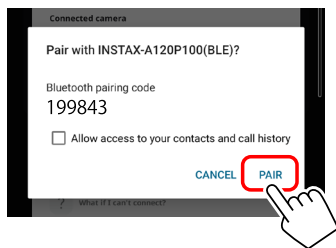

- Depending on your smartphone model, the screen may appear differently.

- 9** Pairing registration is complete.

Shooting

About Shooting

This camera can capture both videos and still images.

Video recording

You can record videos up to 15 seconds long, which are divided into multiple clips.

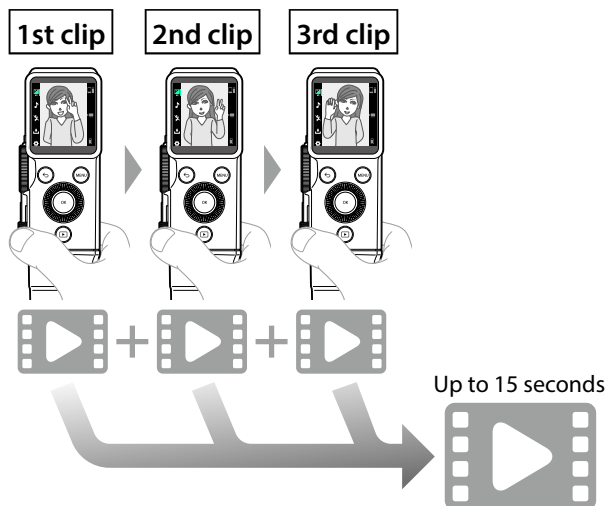

Still image capture

Using the Eras Dial™ effect, you can capture still images with various effects applied.

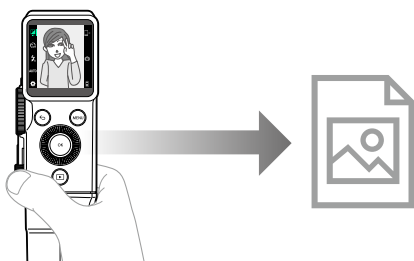

Notes on the Shooting

- When shooting, hold your arms tightly against your body and hold the camera firmly with both hands.
- Be careful not to touch the camera lens when you press the Shutter Button.
- When fully pressing the Shutter Button, press it gently to prevent the camera from moving and causing the blur.
- Be careful not to let your fingers or the hand strap cover the flash or lens.
- In dark or backlit conditions, the flash may fire when the Shutter Button is pressed fully. You can change the flash settings to prevent the flash from firing. (p. 28)

Precautions regarding the internal memory

- If the internal memory is full, the shutter will not release and you will not be able to shoot. Delete videos/still images or use a memory card.
- If the camera malfunctions, videos/still images in the internal memory may be damaged or lost.
- We recommend that you copy important videos/still images to another media for backup.
- If you send the camera in for repair, we cannot guarantee the data in the internal memory.
- When the camera is repaired, we may need to check the data in the internal memory.

Shooting

Video Recording

The basic video recording procedure is as follows:

- 1 Turn on the power and set the CINE/STILL Mode Switch to "CINE".

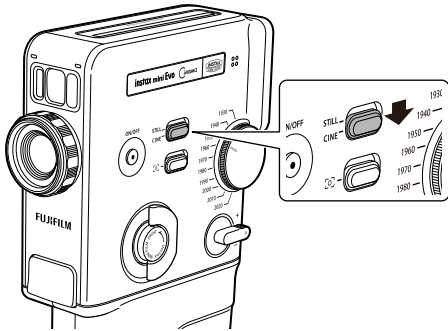

- 2 Use the Eras Dial™ to select the Eras Dial™ effect and use the Degree Control Dial to adjust the intensity of the Eras Dial™ effect.

Choose from ten Eras Dial™ effects and adjust their intensity.

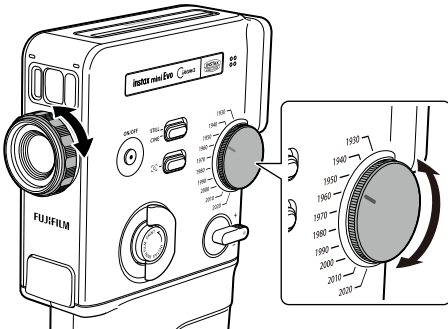

For details on Eras Dial™ effect, see 'Eras Dial™ Effect' (p. 25).

- 3 Set the Frame Switch to on when applying the Eras Dial™ effect frame.

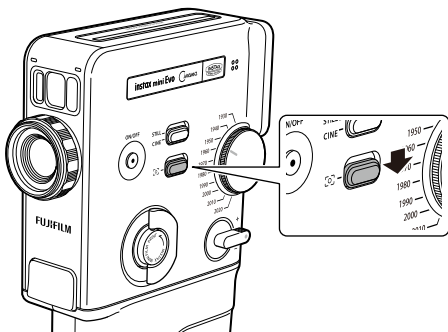

- Slide the Frame Switch downwards until the green color is visible.

- 4 Hold the camera.

- 5 Determine the composition.

Move the Zoom Lever up or down to adjust the composition. Move the Zoom Lever towards + side to zoom into the scene, or move the Zoom Lever towards – side to zoom out of the scene.

You can also use the Zoom Lever while shooting.

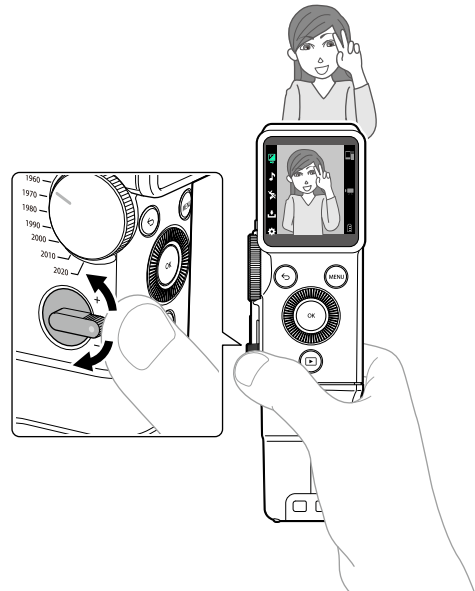

- 6 Press and hold the Shutter Button to start recording.

The video will continue to record for as long as the Shutter Button is held down.

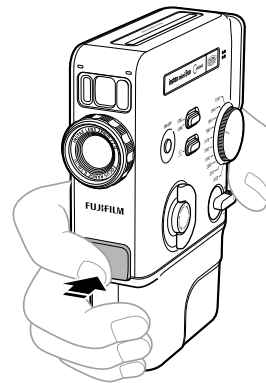

The elapsed time is displayed on a gauge. When there are 3 seconds remaining, the gauge turns red, and when there is 1 second remaining, it starts to flash.

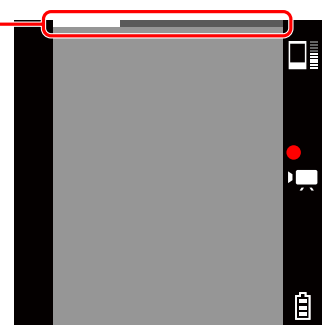

- When the total video length reaches 15 seconds, recording will stop automatically.
- The Shutter Button operation during video recording can be changed in the SHOOTING menu under [SHUTTER BUTTON SETTINGS FOR VIDEO MODE].

Shooting

7 Release the Shutter Button

Video recording will pause, and the last captured clip will play back.

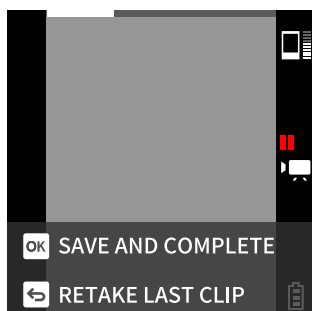

8 Select the next operation.

■ Proceed to the next shot

Pressing the Shutter Button halfway returns you to the preparation screen for shooting the next shot. Repeat steps 6 to 8.

- On the preparation screen, you can reset the Eras Dial™ effects.
- After returning to the preparation screen, if you want to save the video you just recorded, select [SAVE AND COMPLETE] from the direct menu.

■ Finish recording and save

Pressing the OK Button saves the video recorded up to this point to the internal memory or the memory card.

■ Reshoot the previous take

Pressing the Back Button deletes the most recently recorded video and allows you to record again.

Saving the Video via the Direct Menu

If you press the Shutter Button halfway without saving the video, you can save the video via the direct menu.

1 Press the MENU Button.

The direct menu appears.

2 Select [↓].

The videos you have recorded so far are saved to the internal memory or the memory card.

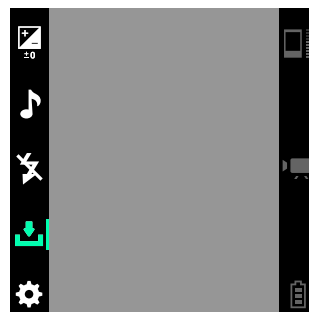

Change the Shutter Operation Method While Shooting

The SHOOTING MENU allows you to adjust the operation of the Shutter Button during video recording.

- 1 Press the MENU Button.
The direct menu appears.
- 2 Select [⚙️].
The setting menu appears.
- 3 Select [SHUTTER BUTTON SETTINGS FOR VIDEO MODE].

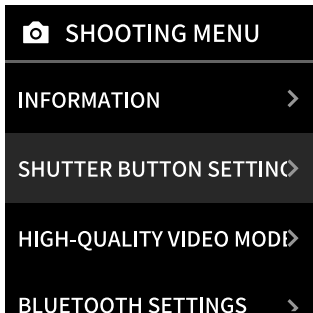

- 4 Change settings.
The settings have been applied and the camera will return to the shooting screen.

PRESS & HOLD TO CAPTURE VIDEO	Press and hold the Shutter Button to start recording a video.
PRESS TO START/STOP RECORDING	Press the Shutter Button once to start recording, and again to stop.

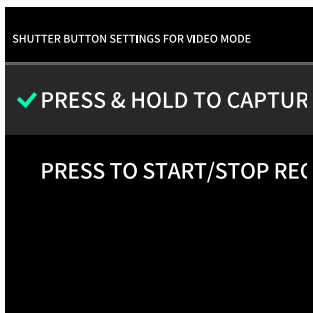

Shooting in High-quality Mode

Video recording in high-quality mode is only available when the Eras Dial™ is set to '2020'. When this mode is activated, both a standard 600×800 pixel video and a 1080×1440 pixel video are saved to the memory card simultaneously.

- If you select '2020' on the Eras Dial™ and set [HIGH-QUALITY VIDEO MODE (2020 ONLY)] to [ON], it will not be possible to record to the internal memory. Use a memory card instead.

- 1 Press the MENU Button.
The direct menu appears.
- 2 Select [⚙️].
The setting menu appears.
- 3 Select [HIGH-QUALITY VIDEO MODE (2020 ONLY)].

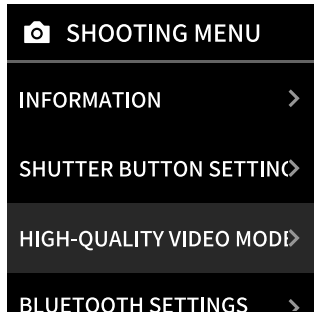

- 4 Select [ON].
The settings have been applied and the camera will return to the shooting screen.

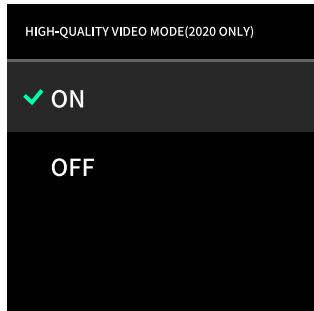

Shooting

Taking Still Images

The basic still image capturing procedure is as follows:

- 1 Turn on the power and set the CINE/STILL Mode Switch to "STILL".

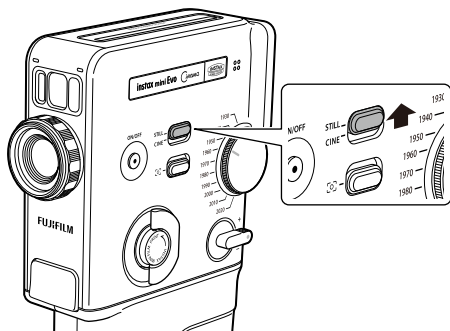

- 2 Use the Eras Dial™ to select the Eras Dial™ effect and use the Degree Control Dial to adjust the intensity of the Eras Dial™ effect.

Choose from ten Eras Dial™ effects and adjust their intensity.

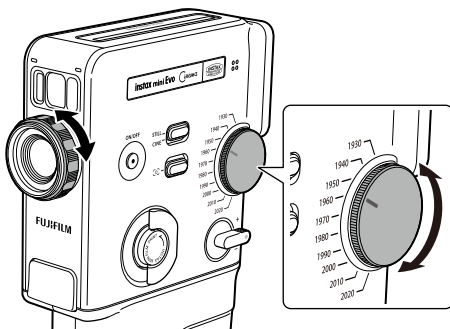

For details on Eras Dial™ effect, see "Eras Dial™ Effect" (p. 25).

- 3 Set the Frame Switch to on when applying the Eras Dial™ effect frame.

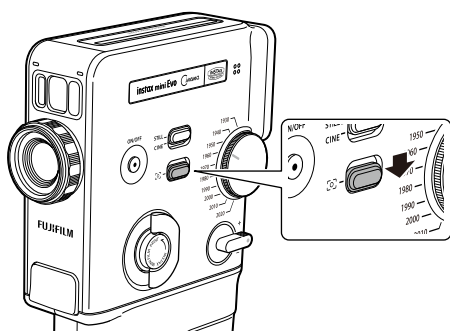

- Slide the Frame Switch downwards until the green color is visible.

- 4 Hold the camera.

- 5 Determine the composition.

Move the Zoom Lever up or down to adjust the composition. Move the Zoom Lever towards + side to zoom into the scene, or move the Zoom Lever towards – side to zoom out of the scene.

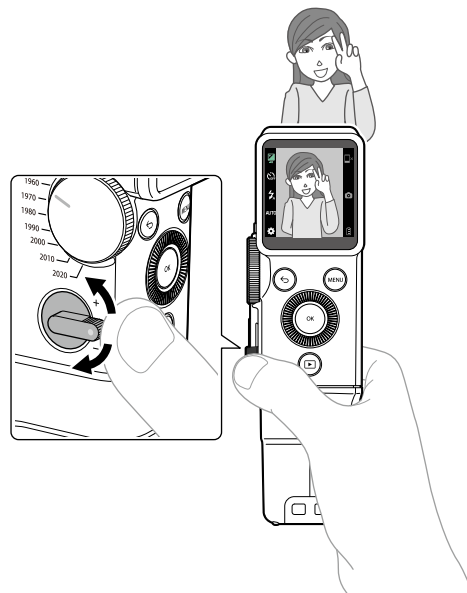

- 6 Press the Shutter Button halfway to focus on the subject.

When the subject is in focus:

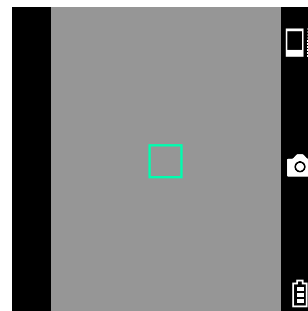

A beep is heard and a green AF frame appears on the LCD Screen.

When [FACE DETECTION] is enabled, a green AF frame appears over the face of the person when the camera recognizes their face. See 'Make Focusing Easier (Still Image)' (p. 29)

When the subject is not in focus:

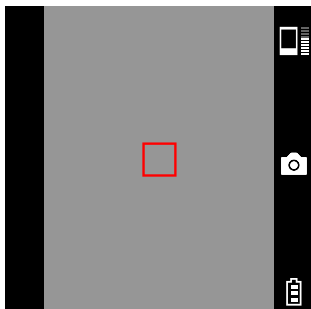

A red AF frame appears on the LCD Screen. Change the composition or use AF/AE lock. See 'Using AF/AE Lock to Take Photos.' (p. 23)

7 Hold the Shutter Button halfway down and press it in (all the way down)

The shutter is released and the photo is taken.

After taking a photo, the image is stored in the internal memory or on the memory card.

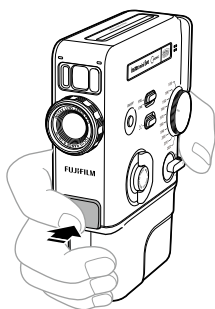

- See 'Printing Still Images' for the procedure to print photos you have taken. (p. 35)

Using AF/AE Lock to Take Photos

When taking a photo, pressing and holding the Shutter Button halfway to lock the focus is called "AF lock," and pressing and holding the Shutter Button to lock the brightness is called "AE lock." This is useful when you want to take a photo where the subject is not in the center of the screen.

- 1 Press the Shutter Button halfway to bring the subject into focus.**
Press the Shutter Button halfway to lock AF or AE.
- 2 Press and hold the Shutter Button halfway to change the composition.**
- 3 Press the Shutter Button fully to take the photo.**

It is recommended that you use AF/AE lock when taking photos of the following objects, as they may be difficult to focus on:

- Shiny objects, such as mirrors and car bodies
- Subjects that are moving at high speed
- Subjects on the other side of glass
- Dark objects, such as hair or fur that absorb light rather than reflect it
- Insustantial objects such as smoke or flames
- Subjects with little difference between light and dark (for example, a person wearing clothes the same color as the background)
- When there is a large contrast difference in the AF frame and the subject is in that area (for example, a subject in front of a high-contrast background)

Shooting

Viewing Recording Information

In shooting mode, pressing the Back Button displays the following information on the LCD Screen. To return to the shooting screen, press the Back Button again.

In the case of videos

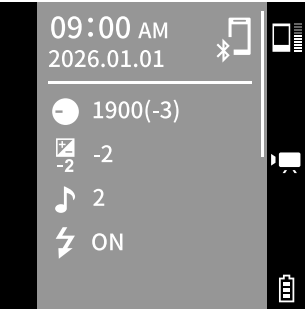

Page 1

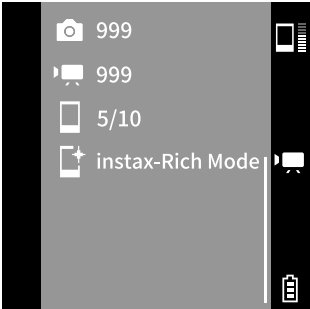

Page 2

In the case of still images

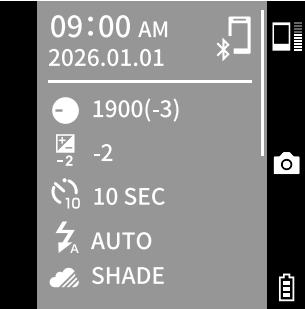

Page 1



Page 2

Shooting

Eras Dial™ Effect

You can shoot using ten different Eras Dial™ effects. You can also adjust the intensity of each effect, as well as shoot using frames designed to complement them.

- If you select '2020' on the Eras Dial™ and set [HIGH-QUALITY VIDEO MODE (2020 ONLY)] to [ON], it will not be possible to record to the internal memory. Use a memory card instead.

1 Select the Eras Dial™ effect.

The selected Eras Dial™ effect will be reflected in the live view.

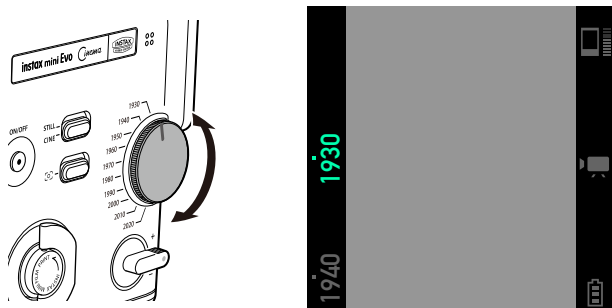

2 Use the Degree Control Dial to adjust the intensity of the Eras Dial™ effect.

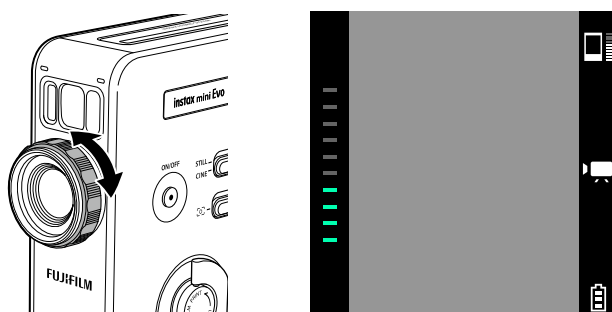

3 To add an Eras Dial™ frame effect, set the Frame Switch to the lower position where the green indicator is visible.

The corresponding frame for the selected Eras Dial™ effect will then be displayed.

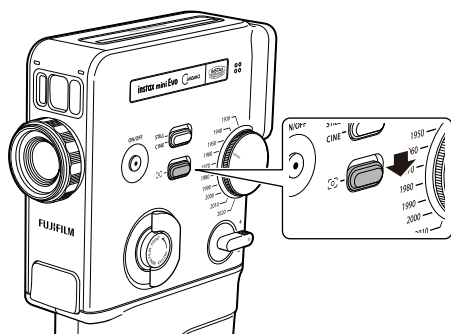

Preview Eras Dial™ Effects

The Eras Dial™ effect can be previewed on the LCD Screen with a selection of different frames available for each effect. To disable the shooting frame, turn the Frame Switch off.

Shooting

Various Shooting — Direct Menu

Press the MENU Button on the shooting screen to display the direct menu to change the following shooting methods.

Displaying the Direct Menu

- 1 Press the MENU Button.
The direct menu appears.

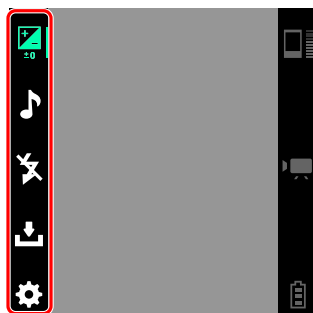

Video recording mode

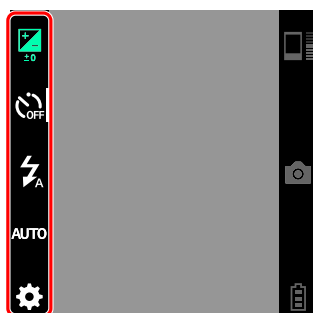

Still image capture mode

Adjusting the Brightness (Video/Still Image)

Adjust the brightness. Use this function when the subject is too bright or too dark, or when the contrast (difference between light and dark) between the subject and the background is too great.

- 1 Select [B&W].

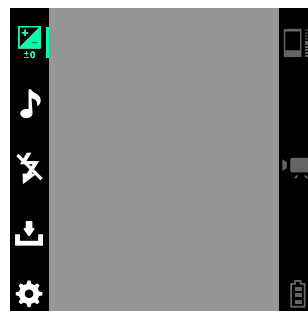

- 2 Correct the exposure.

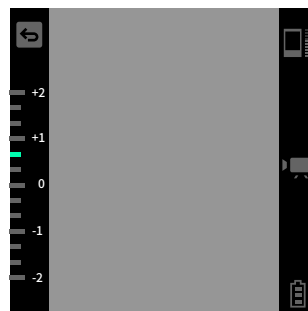

- To brighten, rotate the Select Button/Control Dial clockwise to adjust the exposure to the + side.
- To darken, rotate the Select Button/Control Dial counterclockwise to adjust the exposure to the – side.

Shooting

Adjusting the Volume of Sound Effects (Video)

Depending on the selected Eras Dial™ effect, sound effects may play while you are shooting. You can adjust the volume of these effects.

- However, depending on the selected Eras Dial™ effect, sound effects may not play.

1 Select [🎵].

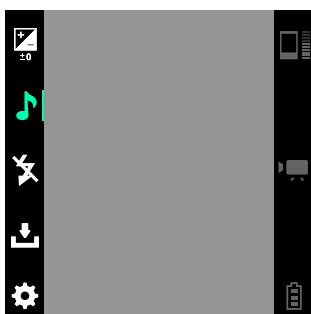

2 Adjust the volume of sound effect.

The volume of sound effect is set.

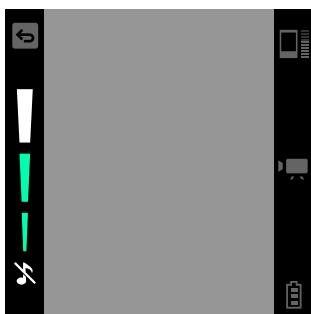

- Selecting [🔇] will mute the sound effect.

Using the Video Light (Video)

Use a video light when shooting at night or in dark indoor environments.

1 Select [💡].

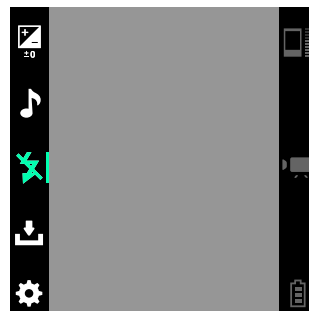

2 Select the video light setting.

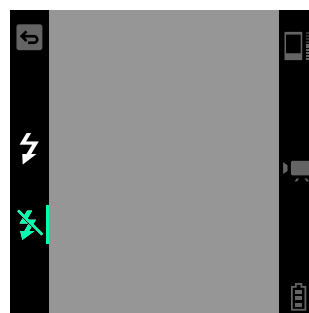

💡 (ON)

The video light illuminates. Use it when the subject is in shadow due to backlighting.

🔇 (OFF)

The video light does not illuminate.

Shooting

Using the Self-Timer to Take Photos (Still Image)

Use this function to take a group photo including the photographer or to prevent the camera from moving while the Shutter Button is pressed.

1 Select [OFF].

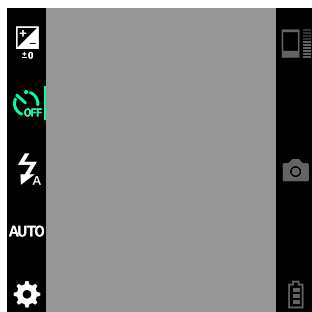

2 Select [2] or [10].

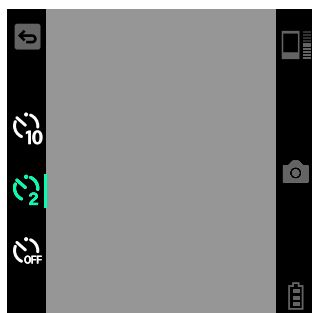

• If you do not want to set a self-timer, select [OFF].

3 Press the Shutter Button all the way down.

The countdown starts.

When [2] is selected:

When you press the Shutter Button, the Self-timer Lamp flashes.

When [10] is selected:

When you press the Shutter Button, the Self-timer Lamp lights up and starts flashing two seconds before taking the photo.

To cancel the self-timer halfway through, press the Back Button.

Taking Photos with the Flash (Still Image)

Use the flash when taking photos at night or in a dark room. You can also set the camera so that the flash does not fire.

1 Select [A].

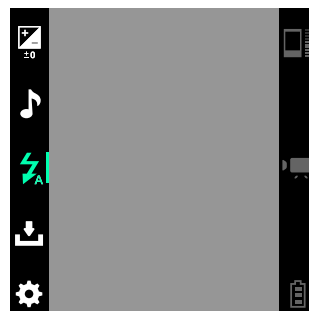

2 Select the flash setting.

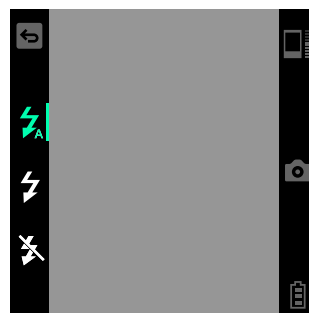

• For more information on flash settings, see “Types of Flash” below.

■ Types of Flash

⚡ AUTO FLASH

The flash will fire automatically when the surroundings are dark. This setting applies to most situations.

⚡ FORCED FLASH

The flash will fire regardless of the brightness of the surroundings. Use this setting when the subject is dark due to backlighting.

✖ SUPPRESSED FLASH

The flash will not fire even if the surroundings are dark. This setting is suitable for shooting in places where flash photography is prohibited.

When shooting in dark places without using the flash, it is recommended to steady the camera on a table or similar surface.

Setting the White Balance (Still Image)

By setting the white balance to match the light source, such as sunlight or artificial lighting, you can shoot with colors closer to real life.

1 Select [AUTO].

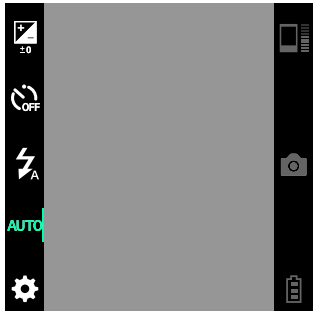

2 Select one of the settings.

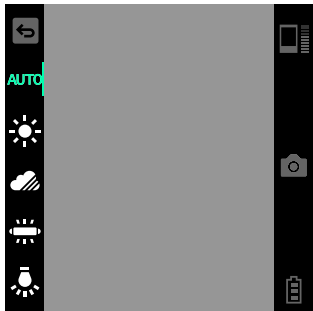

• For details on setting the white balance, see 'Types of White Balance' below.

Types of White Balance

AUTO

The camera sets the white balance automatically. AUTO is recommended for normal shooting.



FINE

For outdoor shooting in fine weather.



SHADE

For shooting on cloudy days or in the shade.



FLUORESCENT LIGHT

For shooting under daylight fluorescent lighting.



INCANDESCENT

For shooting under light bulbs and incandescent lamps.

Make Focusing Easier (Still Image)

Use the setting menu to change the face detection and AF illuminator settings.

1 Press the MENU Button.

The direct menu appears.

2 Select [⚙️].

The setting menu appears.

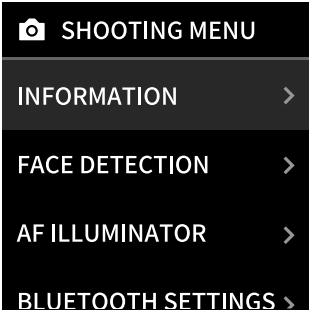

3 Select the item you want to set up and change settings.

• For details on each item, see below.

Adjustable Items

FACE DETECTION

When [FACE DETECTION] is turned on, the camera detects the person's face and adjusts the focus and brightness to the face instead of the background to make the person stand out brightly.

AF ILLUMINATOR

When set to ON, the AF ILLUMINATOR lights from the time the Shutter Button is pressed halfway until the subject is in focus, making it easier to focus on a dark subject.

- Depending on the scene, it may be difficult to get the subject in focus even when the AF ILLUMINATOR is activated.
- The AF ILLUMINATOR may not be fully effective when shooting close to the subject.
- Do not flash the AF ILLUMINATOR close to the human eye.

Playback

Viewing Videos

You can play back the video you have taken on the LCD Screen.

- 1 Turn on the power.**
- 2 Press the Playback Button.**
The camera turns to playback mode.

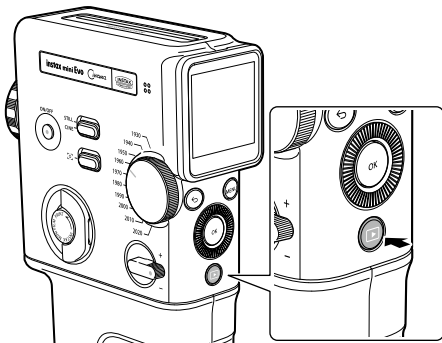

- 3 Select the video you want to play back.**
The selected video is played back.

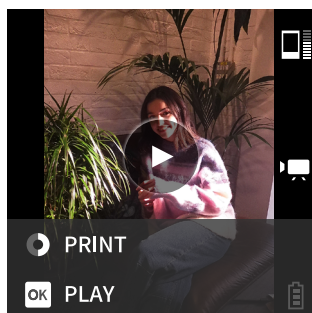

- Press the OK Button to pause the playback.
- Press the Shutter Button fully down or press the Playback Button to return to the shooting screen.

Viewing Still Images

You can play back the still images you have taken on the LCD Screen.

- 1 Turn on the power.**
- 2 Press the Playback Button.**
The camera turns to playback mode.

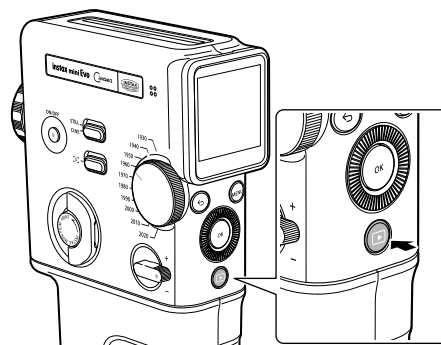

- 3 Select the still image you want to view.**

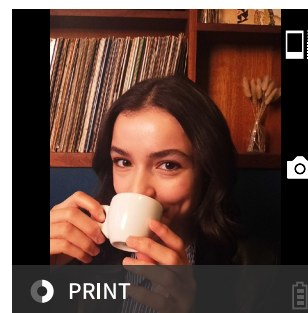

- Press the Shutter Button fully down or press the Playback Button to return to the shooting screen.
- Press the OK Button to switch the operation guide display on or off.

Playback

■ Changing the Number of Videos/Still Images Displayed

Use the Zoom Lever to change the number of videos/photos displayed. Turning it toward “-” displays four images. Turning it toward “+” returns to displaying one image.

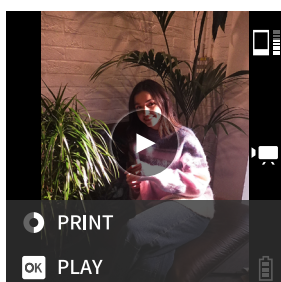
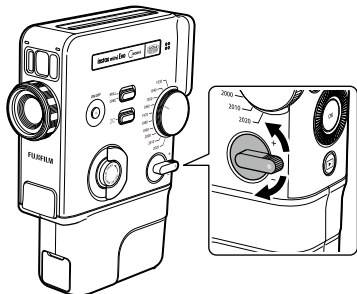

Single-frame display
(Video)



4-frame display

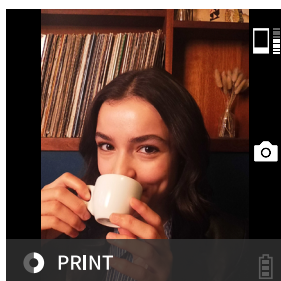

Single-frame display
(Still image)

Adjust the Volume of a Video

- 1 Press the MENU Button.
The direct menu appears.
- 2 Select [🔊].

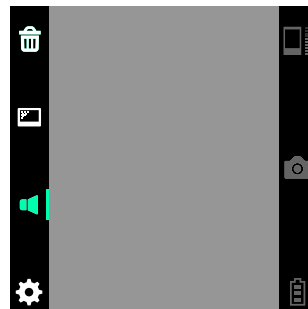

- 3 Select the volume level.
The selected volume will be set.

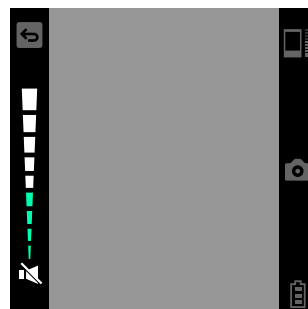

• Selecting [🔇] will mute the audio.

- The videos and still images will be displayed in the order in which they were taken.

Deleting Videos/Still Images

You can delete unwanted videos/still images.

Single-frame Display

- 1 Select the video/still image to be deleted.
- 2 Press the MENU Button.
The direct menu appears.
- 3 Select [🗑️].
- 4 Confirm the video/still image to delete, then press the OK Button.
The selected video/still image will be deleted.

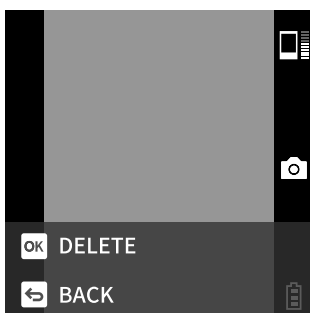

- To cancel deletion, press the Back Button.

4-frame Display

- 1 Press the MENU Button.
The direct menu appears.
- 2 Select [🗑️].
- 3 Select the video/still image you want to delete.
A ✓ mark appears on the selected video/still image.

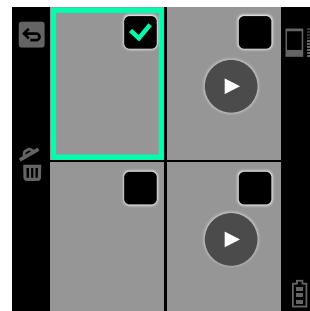

- 4 To delete multiple videos/still images, select the ones you want to delete after completing step 3.

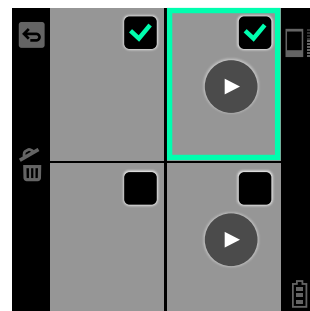

- 5 After selecting all videos/still images you want to delete, select [🗑️] on the left side of the screen.

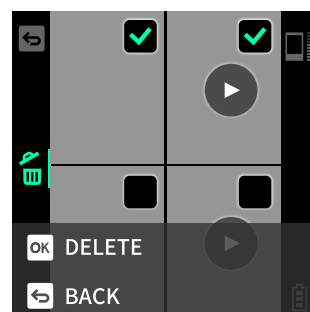

- 6 Confirm the videos/still images to be deleted and press the OK Button.
The selected videos/still images will be deleted.
 - To cancel deletion, press the Back Button.

Playback

Deleting All Videos/Still Images

You can delete all videos/still images at once.

- 1 Press the MENU Button.
The direct menu appears.
- 2 Select [⚙️].
The setting menu appears.
- 3 Select [DELETE ALL IMAGES].

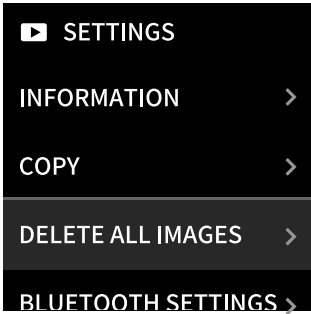

Select [INTERNAL MEMORY] or [CARD].
All videos/still images on the selected media will be deleted.

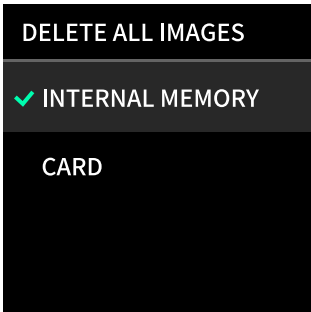

[INTERNAL MEMORY]: Deletes all videos/still images stored in the camera's internal memory.
[CARD]: Deletes all videos/still images stored on the memory card.

Viewing Shooting Information

In playback mode, pressing the Back Button displays the following information on the LCD Screen. To return to the original screen, press the Back Button again.

In the case of videos

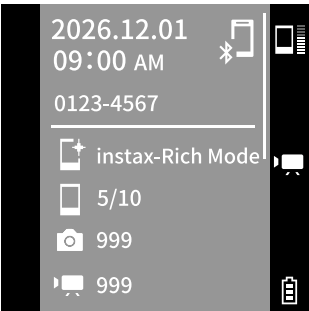

Page 1

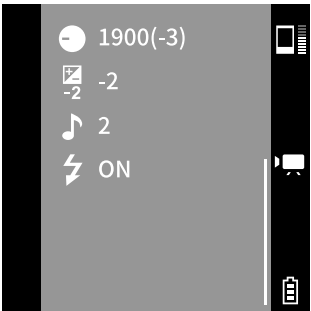

Page 2

In the case of still images

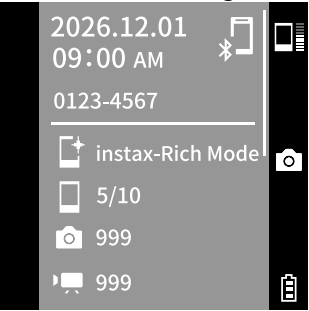

Page 1

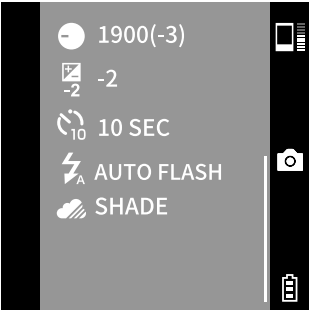

Page 2

Playback

Printing from Videos

You can print an image from a recorded video with a QR code for video playback. When printing, you can select your favorite image from the video. It is also possible to print still images without a QR code.

1 Press the Playback Button.

The camera switches to the playback mode.

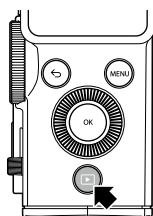

2 Choose the video.

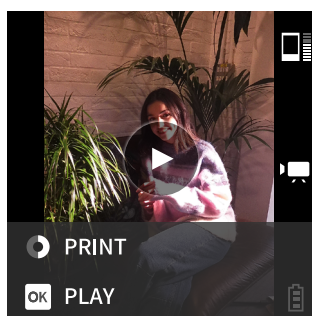

3 Adjust image quality and brightness as required.

For more information, see 'Set the Image Quality and Brightness before Printing' (p. 36).

4 Lift the Print Lever and rotate it 90 degrees counterclockwise.



5 Select the image you want to print, then press the OK Button.

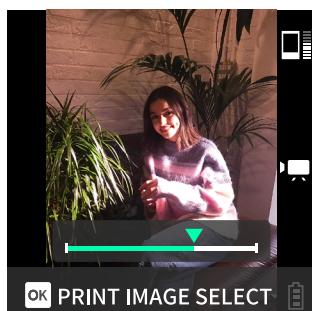

6 Select the position of QR code.

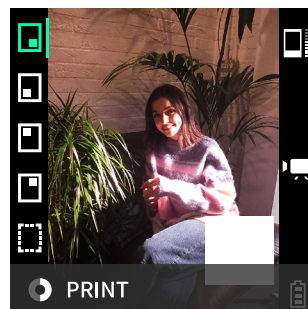

- If you only want to print still images, select [] (without the QR code).

7 Repeat step 4 and the camera will begin printing.

The camera will now print the selected one.

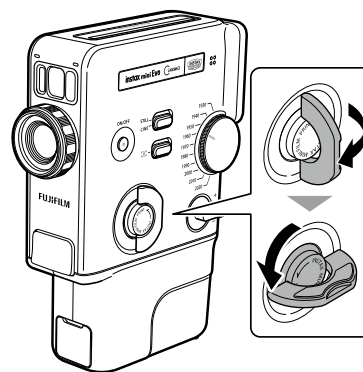

8 After the sound of the film ejecting stops, hold the tip of the ejected film and remove it.

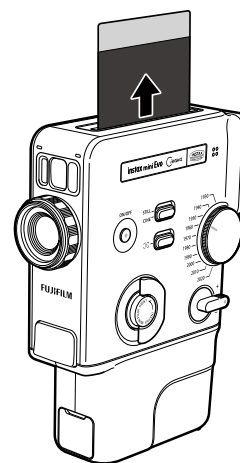

- The [] mark is displayed on the printed image.
- You can also print from [PRINT] on the direct menu.

• Be careful not to let your fingers or the hand strap get caught in the Film Ejection Slot.

Playback

Printing Still Images

You can print still images. Image quality and brightness can be adjusted before printing.

1 Press the Playback Button.

The camera switches to the playback mode.

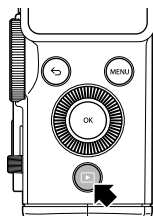

2 Choose the still image you want to print.

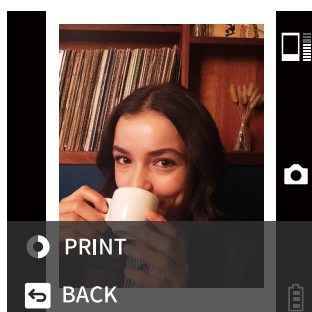

3 Adjust image quality and brightness as required.

For more information, see 'Set the Image Quality and Brightness before Printing' (p. 36).

4 Lift the Print Lever and rotate it 90 degrees counterclockwise.

The camera is now ready to print.

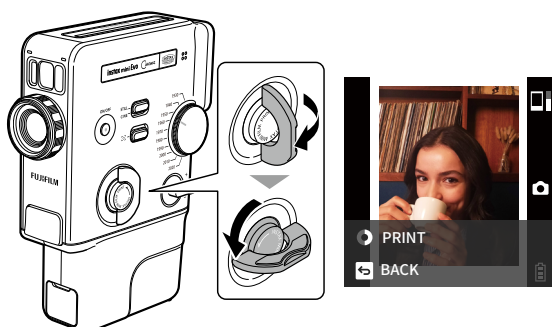

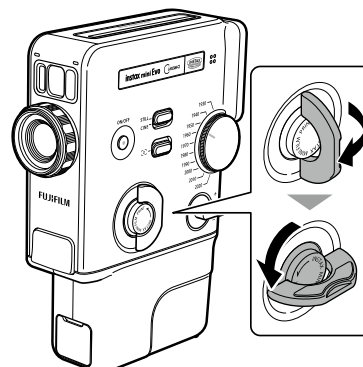

5 Repeat step 4 and the camera will begin printing.

The camera will now print the selected still image.

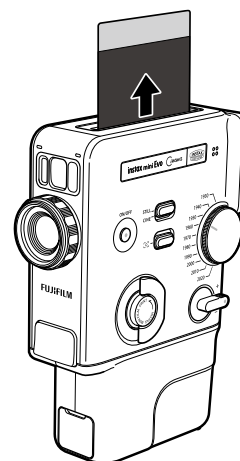

6 After the sound of the film ejecting stops, hold the tip of the ejected film and remove it.



- The  mark is displayed on the printed image.
- You can also print from [PRINT] on the direct menu.

- Be careful not to let your fingers or the hand strap get caught in the film ejection slot.

Playback

Film Remaining Display

The number of remaining film sheets is indicated at the upper-right corner of the screen.

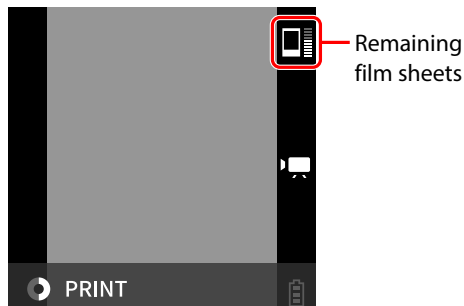

- For details on the handling of film, see the instructions of FUJIFILM instax™ mini instant film.
- Film develops in about 90 seconds (the time varies with temperature).

Set the Image Quality and Brightness before Printing

Selecting Print Quality

You can select the print quality when printing.

- 1 Press the MENU Button.**
The direct menu appears.
- 2 Select [⚙].**
The setting menu appears.
- 3 Select [PRINT QUALITY MODE].**
The PRINT QUALITY MODE menu appears.

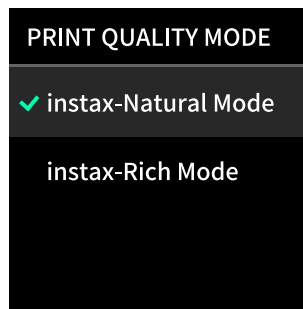

- 4 Select the print quality mode.**
Set to [instax-Natural Mode] for natural colors, or [instax-Rich Mode] for richer and more saturated colors (factory default).
The original screen is displayed.

Adjusting the Brightness of an Image to be Printed

You can adjust the brightness of the image before printing.

1 Press the MENU Button.

The direct menu appears.

2 Select [⚙️].

The setting menu appears.

3 Select [PRINT BRIGHTNESS].

The PRINT BRIGHTNESS menu appears.

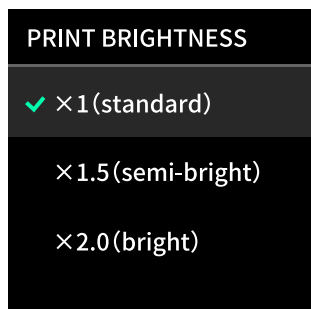

4 Select the print brightness.

Set [×1 (standard)], [×1.5 (semi-bright)], or [×2.0 (bright)].

The original screen is displayed.

Captured Data

Where Shooting Data is Saved

Where your shooting data is saved depends on whether the memory card is inserted or not.

When a Memory Card is not Inserted

If you shoot without inserting a memory card, the shooting data will be saved in the camera's internal memory.

- Be aware of the maximum number of images in the internal memory.

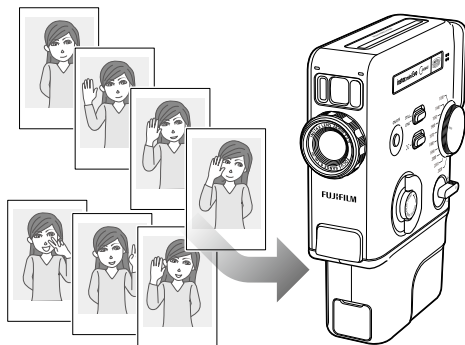

When a Memory Card is Inserted

When a memory card is inserted, data is saved to the memory card and not saved to the camera's internal memory.

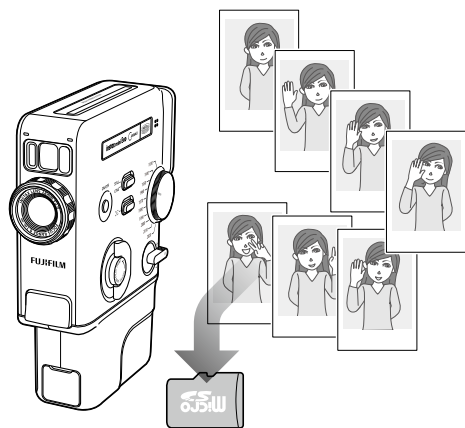

- Data stored in the camera's internal memory or memory card are not automatically deleted. When the videos/still images are full, delete them.

Number of Saved Videos/Still Images

The number of videos/still images that can be saved are shown below.

Number of possible videos/still images

■ Still image

Internal memory	Number of possible still images
Pixel	1920 × 2560
Number of still images	Approximately 50 shots

microSD memory card	Number of possible still images
Pixel	1920 × 2560
Number of still images	Approximately 800 shots per 1 GB

■ Video (STANDARD)

Internal memory	Number of possible clips
Pixel	600 × 800
Number of clips	Approximately 10 clips (1 clip = 15 seconds)

microSD memory card	Number of possible clips
Pixel	600 × 800
Number of clips	Approximately 162 clips per 1 GB (1 clip = 15 seconds)

■ Video (Only for 2020 of Eras Dial™)

Internal memory	Number of possible clips
Pixel	1080 × 1440
Number of clips	0 (not possible)

microSD memory card	Number of possible clips
Pixel	1080 × 1440
Number of clips	Approximately 37 clips per 1 GB (1 clip = 15 seconds)

Setting Menu

Operations and Options in the Setting Menu

Various settings can be changed from the setting menu.

1 Press the MENU Button.

The direct menu appears.

2 Select [⚙️].

The SHOOTING MENU is displayed during shooting and the SETTINGS menu during playback.

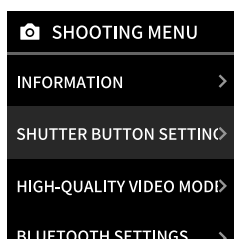

Video recording mode

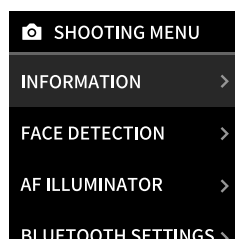

Still image capture mode

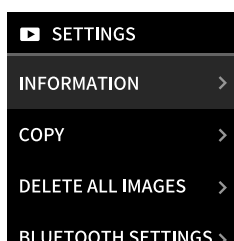

Playback mode

3 Select the item.

- For more information on each item, see the following 'Items in the Setting Menu' (p. 39).

4 Change settings.

5 Press the OK Button.

The settings are applied and the camera returns to the original screen.

Items in the Setting Menu

■ When in the video recording mode

INFORMATION

Displays information on shooting settings.

SHUTTER BUTTON SETTINGS FOR VIDEO MODE

Selects the Shutter Button operation method for video recording. Selecting [PRESS & HOLD TO CAPTURE VIDEO] will start recording when the Shutter Button is pressed and stop when it is released. Selecting [PRESS TO START/STOP RECORDING] will start recording when the Shutter Button is pressed once and stop when pressed again.

HIGH-QUALITY VIDEO MODE (2020 ONLY)

When the Eras Dial™ effect is set to '2020', selecting [ON] enables high-quality recording. Select [OFF] when not in use.

BLUETOOTH SETTINGS

[PAIRING REGISTRATION]:

When you connect with your device via Bluetooth for the first time, you will need to pair the devices. Please refer to "Pairing Settings" (p. 16).

[DELETE PAIRING REG]:

You can delete information of your device registered for pairing.

[INFORMATION]:

Displays the Bluetooth address, device name, and registered paired devices.

PRINT QUALITY MODE

Set to [instax-Natural Mode] for natural colors, or [instax-Rich Mode] for richer and more saturated colors (factory default).

PRINT BRIGHTNESS

Set [×1 (standard)], [×1.5 (semi-bright)], or [×2.0 (bright)].

DATE/TIME

Sets the date and time.

言語/LANG.

Sets the language displayed on the LCD Screen.

SOUND VOLUME SET-UP

Sets the volume of the operation sound, shutter volume, and start-up sound.

If you want to turn off the sound, set this to [🔇].

AUTO POWER OFF

Sets the time to turn off automatically when the camera is not operated. You can select from [2 MIN], [5 MIN] and [OFF].

RESET

Resets the settings to the factory default values.

The date and time set in DATE/TIME will not be reset.

FORMAT

Initializes the camera's internal memory or a memory card inserted in the card slot. All stored videos/still images will be deleted.

FIRMWARE UPGRADE

Upgrades the firmware.

For upgrade details, see 'Upgrading the Firmware' (p. 41)

Setting Menu

■ When in the still image capture mode

INFORMATION

Displays information on shooting settings.

FACE DETECTION

When [FACE DETECTION] is turned on, the camera detects the person's face and adjusts the focus and brightness to the face instead of the background to make the person stand out brightly.

AF ILLUMINATOR

When set to [ON], the AF ILLUMINATOR lights from the time the Shutter Button is pressed halfway until the subject is in focus, making it easier to focus on a dark subject.

BLUETOOTH SETTINGS

[PAIRING REGISTRATION]:

When you connect with your device via Bluetooth for the first time, you will need to pair the devices. Please refer to "Pairing Settings" (p. 16).

[DELETE PAIRING REG]:

You can delete information of your device registered for pairing.

[INFORMATION]:

Displays the Bluetooth address, device name, and registered paired devices.

PRINT QUALITY MODE

Set to [instax-Natural Mode] for natural colors, or [instax-Rich Mode] for richer and more saturated colors (factory default).

PRINT BRIGHTNESS

Set [×1 (standard)], [×1.5 (semi-bright)], or [×2.0 (bright)].

DATE/TIME

Sets the date and time.

言語/LANG.

Sets the language displayed on the LCD Screen.

SOUND VOLUME SET-UP

Sets the volume of the operation sound, shutter volume, and start-up sound.

If you want to turn off the sound, set this to [🔇].

AUTO POWER OFF

Sets the time to turn off automatically when the camera is not operated. You can select from [2 MIN], [5 MIN] and [OFF].

RESET

Resets the settings to the factory default values.

The date and time set in DATE/TIME will not be reset.

FORMAT

Initializes the camera's internal memory or a memory card inserted in the card slot. All stored images will be deleted.

FIRMWARE UPGRADE

Upgrades the firmware.

For upgrade details, see 'Upgrading the Firmware' (p. 41)

■ When in the playback mode

INFORMATION

Displays information on shooting settings.

COPY

Copies videos/still images from the internal memory to the memory card or from the memory card to the internal memory. Follow the steps below.

1. Select [COPY] from the SETTINGS menu.
2. Select the source and destination of copying and press the OK Button.
3. Select [FRAME] or [ALL FRAMES] and press the OK Button.
4. If you select [FRAME], select the videos/still images to be copied and press the OK Button to start copying.
If you select [ALL FRAMES], press the OK Button to start copying.

DELETE ALL IMAGES

Deletes all videos/still images in the internal memory or the memory card inserted in the card slot at once.

BLUETOOTH SETTINGS

[PAIRING REGISTRATION]:

When you connect with your device via Bluetooth for the first time, you will need to pair the devices. Please refer to "Pairing Settings" (p. 16).

[DELETE PAIRING REG]:

You can delete information of your device registered for pairing.

[INFORMATION]:

Displays the Bluetooth address, device name, and registered paired devices.

PRINT QUALITY MODE

Set to [instax-Natural Mode] for natural colors, or [instax-Rich Mode] for richer and more saturated colors (factory default).

PRINT BRIGHTNESS

Set [×1 (standard)], [×1.5 (semi-bright)], or [×2.0 (bright)].

DATE/TIME

Sets the date and time.

言語/LANG.

Sets the language displayed on the LCD Screen.

SOUND VOLUME SET-UP

Sets the volume of the operation sound, shutter volume, and start-up sound.

If you want to turn off the sound, set this to [🔇].

AUTO POWER OFF

Sets the time to turn off automatically when the camera is not operated. You can select from [2 MIN], [5 MIN] and [OFF].

RESET

Resets the settings to the factory default values.

The date and time set in DATE/TIME will not be reset.

FORMAT

Initializes the camera's internal memory or a memory card inserted in the card slot. All stored images will be deleted.

FIRMWARE UPGRADE

Upgrades the firmware.

For upgrade details, see 'Upgrading the Firmware' (p. 41)

Setting Menu

■ Upgrading the Firmware

There are two ways to upgrade the firmware; when upgrading via PC, prepare the memory card in advance.

● Using the “instax mini Evo™” smartphone app

1. Launch the “instax mini Evo™” smartphone app.
2. Tap [Device upgrade] in the Set-up menu.
3. Tap [OK].
4. Follow the on-screen instructions.

● Using the Camera

1. Download the latest firmware from the FUJIFILM website using a PC or other device, and copy it to the root directory of the memory card.
2. Insert the memory card with the copied firmware into the camera card slot.
3. Select [FIRMWARE UPGRADE] in the SETTINGS menu.
4. Follow the on-screen instructions.

Overview of the App

Smartphone App Linked Functions

The following functions are available when connected with the "instax mini Evo™" smartphone app.

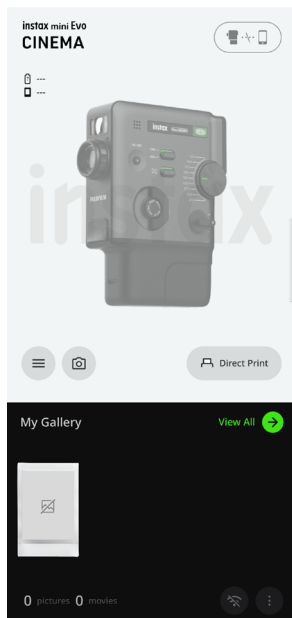

● Gallery

Use Bluetooth or Wi-Fi to transfer videos and still images captured with the camera to the smartphone app. These can then be viewed in the app's gallery.

● Video Editing

Edit videos transferred to the app. The app allows you to combine multiple videos, opening & ending sequences and poster templates.

● Direct Print

You can send images from your smartphone to the camera for printing.

● Saving Screenshots Printed from Videos/Images

You can save printed photos taken with the camera to the smartphone app. You can add instax™ frames to your videos/still images and save them on your smartphone.

● Remote Shooting

Control the camera's shutter release with your smartphone for easy remote shooting moments.

Installing the Smartphone App

Please install the instax mini Evo™ smartphone app before using the camera.

- If you are using an Android OS smartphone, please search for the instax mini Evo™ smartphone app in the Google Play Store and install it.

*Requirements for Android OS smartphones: Android Ver. 10.0 or higher with Google Play Store installed

- If you are using an iOS smartphone, please search for the instax mini Evo™ smartphone app in the App Store and install it.

*Requirements for iOS smartphones: iOS Ver. 15.0 or higher

- Even if you have downloaded the app and your smartphone meets the above requirements, you may not be able to use the instax mini Evo™ smartphone app. This is dependent upon your smartphone model.

Visit the instax mini Evo™ app download site for the latest information on system requirements.

- Scan to download the instax mini Evo™ smartphone app



iOS



Android OS

The text QR code itself is a registered trademark and wordmark of Denso Wave Incorporated.

- 1 Open the "instax mini Evo™" app.
- 2 Review the confirmation items relating to photo and media access, then tap [Allow].
- 3 Read the terms of use, and tap [Agree].
- 4 Select your region then tap [Next].
If you are using the camera in Europe, select [Europe].
- 5 Tap [Next].
- 6 Read the privacy policy, check [I agree to the privacy policy], and tap [Agree].
- 7 Select [instax mini Evo Cinema] and tap [OK].
- 8 Tap [Go to Bluetooth connection settings].
- 9 When the camera is detected, tap [Connect].
If multiple cameras are detected, select the camera to connect from the list.
The camera's identifier (device name) is located on the bottom of the camera.
- 10 Enter the serial number of the camera, and tap [Connect].
- 11 Tap [Next].
- 12 A quick-start guide is displayed. Read the instructions and tap [OK].
The app is ready.

Other Information

Specifications

■ Camera Function

Image sensor	1/5-inch CMOS with primary color filter
Number of effective pixels	Approximately 5 million pixels
Number of recorded pixels	Still image capture: 1920 × 2560 Video capture/STANDARD: 600 × 800 Video capture/HIGH-QUALITY VIDEO MODE (2020 ONLY): 1080 × 1440
Storage media	Internal memory, microSD/microSDHC/microSDXC (up to 256GB) memory card
Storage capacity	(Still Images) Internal memory: Approximately 50 shots When using microSD / microSDHC memory card, Approximately 800 shots per 1GB at 1920 × 2560 pixels (Video / STANDARD) Internal memory: Approximately 10 clips When using microSD / microSDHC memory card, Approximately 162 clips per 1GB at 600 × 800 pixels (each clip Approximately 15 seconds) (Video / HIGH-QUALITY VIDEO MODE (2020 ONLY)) Internal memory: 0 clips (Not supported) When using microSD / microSDHC memory card, Approximately 37 clips per 1GB at 1080 × 1440 pixels (each clip Approximately 15 seconds)
Recording method	JPEG DCF compliant Exif Ver 2.3
Focus distance	f = 28mm (35 mm film equivalent)
Aperture	F2.0
Auto focus	Single AF, Face recognition AF (on/off) (with auxiliary light)
Shooting distance	10 cm to ∞
Shutter speed	1/4 second to 1/8000 second (automatic switching)
Shooting sensitivity	ISO100 to 1600 (automatic switching)
Exposure control	Program AE
Exposure compensation	−2.0 EV to +2.0 EV (1/3 EV step)
Metering method	TTL 256 split metering, multi metering
White balance	AUTO, FINE, SHADE, FLUORESCENT LIGHT, INCANDESCENT
Flash	AUTO FLASH/FORCED FLASH/SUPPRESSED FLASH Shooting range with flash: Approximately 50 cm to 1.5 m

Self-timer	Approximately 2 seconds / approximately 10 seconds
Movie recording	MP4 MPEG-4 AVC/H.264 AAC
Movie frame rate	24p
Movie bitrate	STANDARD: 2.5 Mbps HIGH-QUALITY: 9.0 Mbps
Eras Dial™ effect	10 Eras Dial™ effects with degree control functions. (1930/1940/1950/1960/1970/1980/1990/2000/2010/2020)

■ Print function

Exposure pixel count	1600 × 600 dots (800 × 600 dots when printed from smartphone app)
Exposure resolution	25 dots/mm × 12.5 dots/mm (635 × 318 dpi, 40 × 80 μm dot pitch) 12.5 dots/mm when printed from smartphone app (318 dpi, 80 μm dot pitch)
Exposure gradation	RGB gradation of 256 colors
Printable image format	From the camera's internal memory or microSD / microSDHC / SDXC memory card: JPEG images taken with this camera From a smartphone: JPEG, PNG, HEIF
Print output time	Approximately 16 seconds * Plus approximately 7 seconds when printed using instax-Rich Mode™ immediately after startup.
Print function	Images in the internal memory and images in the memory card can be printed

■ Other

Smartphone app linked functions	Smartphone image print function, remote shooting function, printed image transfer function, firmware upgrade function
LCD screen	1.54-inch TFT color LCD screen Pixel count: Approximately 170,000 dots
External interface	USB Type-C port (for charging only)
Bluetooth	Bluetooth Ver. 5.4 (Bluetooth low energy)
Wireless Transmitter	IEEE802.11b/g/n (2.4 GHz band only) Encryption: WPA/WPA2 mixed mode, WPA3 Access Mode: Infrastructure
Power supply	Lithium ion battery (internal type: not removable)
Power consumption	Power Off: Approximately 0.3 mW Power On : Approximately 2.3 W (During video recording)

Other Information

Auto power off function	5 minutes / 2 minutes / Off * Deactivating the auto power off function will increase the energy consumption of the product.
Possible number of printed images	Approximately 100 (from full charge) *The number of prints depends on the usage conditions.
Charging time	Approximately 2 to 3 hours *Charging time depends on the temperature.
Main unit dimensions	39.4 mm × 132.5 mm × 100.1 mm (excluding projecting parts)
Main unit weight	Approximately 270 g (Film cartridges, recording media, not included.)
Operating environment	Temperature: 5°C to 40°C Humidity: 20% to 80% (no condensation)
Film used	FUJIFILM instax™ mini Instant Film (sold separately)

*The above specifications are subject to change for better performance.

Troubleshooting

Please check the following items before considering the problem to be a malfunction. If the problem persists even after taking action, please contact the FUJIFILM service center for repair in your country or visit the website below:

FUJIFILM website: <https://www.fujifilm.com/>

If the following problem occurs...

Problem	Possible causes and solutions
I cannot turn the camera on.	The battery may be exhausted. Please charge the camera.
The battery is exhausted quickly.	If you use the camera in a very cold environment, the battery will drain quickly. Please keep the camera warm before shooting.
Camera shuts down during use.	The battery level may be low. Please charge the camera.
Charging does not start.	<ul style="list-style-type: none"> • Make sure that the USB power adapter plug is properly connected to the power outlet. • Turn off the camera when charging it. If power is on, camera will not charge.
It takes too long to charge.	At low temperatures, charging may take longer.
The Charging Lamp flashes while charging.	Charge the battery in a temperature range of +5°C to +40°C. If you cannot charge the battery within this range, please contact our support center.
I cannot take photos when I press the Shutter Button.	<ul style="list-style-type: none"> • Make sure that the power is on. • If the battery level is low, please charge the camera. • If the internal memory or memory card is full, insert a new memory card or delete unnecessary images. • Use a memory card formatted with this unit. • If the contact surface of the memory card (gold part) is dirty, wipe it with a soft, dry cloth. • The memory card may be broken. Please insert a new memory card.
I cannot focus the camera during still image shooting.	Use the AF/AE lock to shoot subjects that are difficult to focus on.
The flash does not fire.	Check that the suppressed flash setting has not been selected. Select a setting other than the suppressed flash setting.
Even though the flash fired, the image is dark.	<ul style="list-style-type: none"> • Check that you are not too far from the subject. Please shoot within the flash range. Approximately 30 cm to 1.5 m. • Hold the camera correctly so that you do not obstruct the flash with your fingers.

Other Information

Problem	Possible causes and solutions
The image is blurred.	<ul style="list-style-type: none">• If the lens has dirt on it such as fingerprints, clean the lens.• Make sure that the AF frame is green before taking a photo.
The camera does not work properly.	<ul style="list-style-type: none">• There may be a temporary malfunction. Please press the Reset Button. If it still does not work properly, please contact our repair service center for repair.• The battery may be exhausted. Please charge the camera.
The film cartridge does not load or does not load smoothly.	<ul style="list-style-type: none">• Please use FUJIFILM instant film "instax™ mini" (other films cannot be used).• Align the yellow mark on the film cartridge with the yellow alignment mark on the camera body to load the film.
The film does not unload.	<ul style="list-style-type: none">• The film may be misaligned due to shocks such as vibration or dropping. Please load a new film cartridge.• If the film is jammed, turn off the camera and turn it on again. If the problem persists, remove the jammed film and then load a new film cartridge.
Some or all of the finished prints are white.	Do not open the film door until all film sheets have been used. Unexposed film will be prematurely exposed if the door is opened. Prematurely exposed film will be white with no images.
The print is uneven.	<ul style="list-style-type: none">• Do not shake, bend, fold or hold the print immediately after it is printed.• Do not obstruct the Film Ejection Slot.
The camera is malfunctioning and cannot be turned off.	Press the Reset Button next to the Micro SD Card Slot to turn off the power. (p. 7)

Other Information

Notes on Disposing of the Camera

A lithium-ion battery inside the camera is used for this camera. When you dispose of the camera, follow your local regulations and waste handling guidelines to dispose of it properly. For inquiry, please scan the QR code and refer to the Contact Information.



If your country or region is not included in the list, please contact your local distributor.



Disposal of Electrical and Electronic Equipment in Private Households
Disposal of used Electrical & Electronic Equipment (Applicable in the European Union and other European countries with separate collection systems)

This symbol on the product, or in the manual and in the warranty, and/or on its packaging indicates that this product should not be treated as household waste. Instead it should be taken to an appropriate collection point for the recycling of electrical and electronic equipment.

By ensuring this product is disposed of correctly, you will help prevent potential negative consequences to the environment and human health, which could otherwise be caused by inappropriate waste handling of this product.

The recycling of materials will help to conserve natural resources. For more detailed information about recycling of this product, please contact your local city office, your household waste disposal service or the shop where you purchased the product. In countries outside of the EU: If you wish to discard this product, please contact your local authorities and ask for the correct method of disposal.



This symbol on the batteries or accumulators indicates that those batteries should not be treated as household waste.

For customers in Turkey:

EEE Complies with Directive.

Removing the Battery

Dispose the battery according to the instructions of the recycling center and local government.

Open the Film Door and remove the Film Cartridge.

- 1 Remove the battery cover using a screwdriver (sold separately).

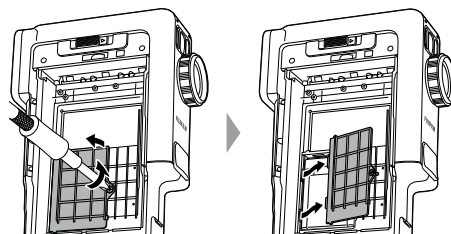

- 2 Pull out the wiring, remove the connector, and pull the battery out.

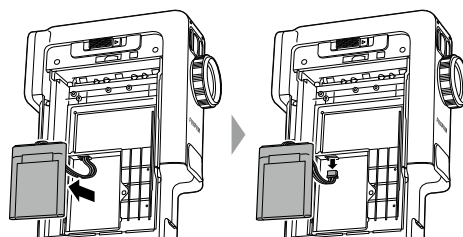

Installing a Battery

- 1 Connect the connector and insert the replacement battery into the camera.

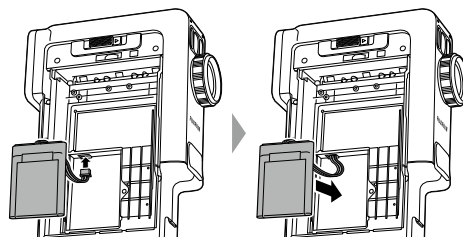

- 2 Place the cover on the camera and secure it with the screw.

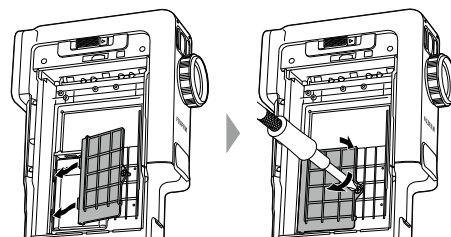

- For information on obtaining replacement batteries, contact the service center listed on the separate sheet.
- The battery is a dedicated item for the "instax mini Evo Cinema™".

Other Information

IMPORTANT SAFETY NOTICE

This product has been designed with safety in mind and to also provide safe service when handled correctly in accordance with the User's Guide and the instructions provided. It is important that both the product and the instax™ mini film are handled properly and used only to print photos as instructed in the User's Guide and in the instax™ mini film instructions. For your ease and safety, please follow what is written in the User's Guide.

WARNING

This symbol indicates danger, which could result in injury or death. Please follow these instructions.

- ⚠ If one of the following cases occurs, immediately unplug the supplied USB Type-C cable, turn the camera off and refrain from using the camera. Contact the FUJIFILM service center; otherwise heat generation or fire may occur:
 - The camera becomes hot, emits smoke, has a burnt smell, or otherwise seems abnormal.
 - The camera is dropped into water, or foreign objects like water or metal get inside the camera.
- ⚠ As the battery is located inside the camera, do not subject it to heat, throw it into an open fire, attempt to drop it, or apply impact to it. Doing so could cause the camera to explode.
- ⚠ Never take flash photographs of people riding bicycles, driving cars, skateboarding, riding a horse and the like. The flash can be startling, distracting and can frighten animals. This could potentially cause an accident.
- ⚠ Never get this product wet or handle it with wet hands. Doing so may result in an electric shock.
- ⚠ Keep out of the reach of small children. This product could cause injury in the hands of a child.

CAUTION

This indicates a matter that may lead to injury or physical damage if ignored or incorrectly handled.

- ⚠ Never attempt to take this product apart. You may be injured.
- ⚠ If anything is wrong with the camera, never attempt to repair it by yourself. You may be injured.
- ⚠ If this product is dropped or damaged so that the inside is showing, do not touch it. Contact your FUJIFILM dealer.
- ⚠ Do not touch any parts or projecting parts inside the Film Door. You may be injured.
- ⚠ Promptly unplug the supplied USB Type-C cable once the battery is fully charged.
- ⚠ Do not cover or wrap the camera or the AC power adapter in a cloth or blanket. This can cause heat to build up and distort the casing or cause a fire.

	The "CE" mark certifies that this product satisfies the requirements of the EU (European Union) regarding safety, public health, environment and consumer protection. ("CE" is the abbreviation of Conformité Européenne.)
---	--

Hereby, FUJIFILM declares that the radio equipment type FI041 is in compliance with Directive 2014/53/EU.

For more information, access the website below:
https://instax.com/support/declaration/#hybrid_cameras

	The "UKCA" mark certifies that this product satisfies the requirements of Great Britain (England, Scotland, Wales) regarding safety, public health, environment and consumer protection. *UKCA: UK Conformity Assessed.
---	--

Simple Camera Care

■ Camera Care

1. Do not open the film door until you have used up all of the film; otherwise, the rest of the film is exposed and turns white. The film can no longer be used.
2. Your camera is a fragile object. Do not expose it to water, sand or gritty materials and do not drop.
3. Do not use a strap made for cellular phones or other similar electronic products. These straps are usually too weak to hold your camera securely. For safety, only use straps designed for your camera, and use only as specifically intended and instructed.
4. Do not use solvent such as thinner or alcohol to remove dirt.
5. Do not leave your camera in direct sunlight, or hot places such as a car. Do not leave it in damp places for long periods.
6. Moth repellent gas such as naphthalene may affect your camera and prints. Be careful to keep your camera and prints in a safe, dry place.
7. Note that the temperature range within which your camera can be used is +5°C to +40°C.
8. Take great care to ensure that printed materials do not violate copyright, image rights, privacy or other personal rights and do not offend public decency. Actions that violate the rights of others, are contrary to public decency or constitute a nuisance may be punishable by law or otherwise legally actionable.
9. This camera is for general household use. It is not suitable for commercial photography and other applications where a large number of prints are used.

■ Handling the LCD Screen

As the LCD Screen can be easily scratched or damaged by sharp or solid objects, we recommend you attach a protective sheet (commercially available) onto the screen.

■ Charging the Battery

The battery is not charged at shipment. Fully charge the battery before use.
Charge the battery using the supplied USB Type-C cable. Charging times will increase at ambient temperatures below +10°C or above +35°C.
Do not attempt to charge the battery at temperatures above +40°C or at temperatures below +5°C as the battery will not charge.

■ Battery Life

At normal temperatures, the battery can be recharged about 300 times. A noticeable decrease in the length of time the battery will hold a charge indicates that it has reached the end of its service life.

Other Information

■ Caution: When battery is in use

The battery and camera body may become warm to the touch after extended use. This is normal.

■ Certification marks acquired by the camera are located inside the film chamber.

■ Caution: When printing photos

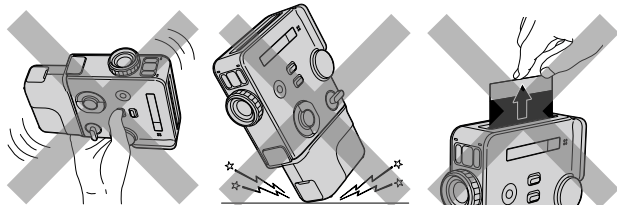

Do not shake the camera while printing.

Do not drop the camera while printing.

Do not cover the film ejection slot while printing.

■ instax™ mini Film and Print Care

See FUJIFILM Instant Film instax™ mini for film use instructions. Follow all instructions for safe and proper use.

1. Keep the film in a cool place. Do not leave the film in a place where the temperature is extremely high (e.g. in a closed car) for many hours.
2. Do not puncture, tear, or cut instax™ mini film. If film becomes damaged, do not use.
3. When you load a film cartridge, use the film as soon as possible.
4. If the film has been kept in a place where the temperature is extremely high or low, bring it to room temperature before starting to print photos.
5. Be sure to use the film before the expiration or "Use Before" date.
6. Avoid airport checked luggage inspection and other strong X-ray illumination. The effect of fogging, etc. may appear on unused film. We recommend that you carry the camera and/or the film onto the aircraft as carry-on luggage. (Check with each airport for more information.)
7. Avoid strong light, and keep the developed prints in a cool and dry place.
8. Do not puncture or cut the film as it contains a small amount of caustic paste (high alkaline). Never let children or animals put the film into their mouth. Also pay attention so that the paste does not come into contact with skin or clothes.
9. If the paste inside the film comes into contact with skin or clothes, immediately wash off with plenty of water. If the paste comes into contact with the eyes or mouth, immediately wash the area with plenty of water and contact a doctor. Note that the alkaline inside the film remains active for about 10 minutes after the photo has been printed.
10. Do not store photos in a sealed bag, as this may cause discoloration.
11. Do not touch the image during development time.

■ Cautions when handling the Film and Photo Prints

For details, refer to the instructions and warnings on FUJIFILM instax™ mini instant film.



Wireless LAN / Bluetooth® Devices: Cautions

IMPORTANT: Read the following notices before using the product's built-in wireless LAN / Bluetooth transmitter.

■ Use only as part of a wireless LAN / Bluetooth network.

FUJIFILM does not accept liability for damages resulting from unauthorized use. Do not use in applications requiring a high degree of reliability, for example in medical devices or other systems that may directly or indirectly impact human life. When using the device in computer and other systems that demand a greater degree of reliability than wireless LAN / Bluetooth networks, be sure to take all necessary precautions to ensure safety and prevent malfunction.

■ Use only in the country in which the device was purchased.

This device conforms to regulations governing wireless LAN / Bluetooth devices in the country in which it was purchased. Observe all location regulations when using the device. FUJIFILM does not accept liability for problems arising from use in other jurisdictions.

■ Wireless data may be intercepted by third parties.

The security of data transmitted over wireless networks is not guaranteed.

■ Do not use the device in locations subject to magnetic fields, static electricity, or radio interference.

Do not use the transmitter in the vicinity of microwave ovens or in other locations subject to magnetic fields, static electricity, or radio interference that may prevent reception of wireless signals. Mutual interference may occur when the transmitter is used in the vicinity of other wireless devices operating in the 2.4 GHz band.

Other Information

■ **The wireless transmitter operates in the 2.4 GHz band.**

The maximum radio-frequency power is 9.44 mW when using a wireless LAN network and 3.07 mW when using Bluetooth devices.

■ **This device operates on the same frequency as commercial, educational, and medical devices and wireless transmitters.**

It also operates on the same frequency as licensed transmitters and special unlicensed low-voltage transmitters used in radio-frequency identification tracking systems for assembly lines and in other similar applications.

■ **To prevent interference with the above devices, observe the following precautions.**

Confirm that the radio-frequency identification transmitter is not in operation before using this device. If you notice that this device causes interference in low-voltage radio-frequency identification tracing systems, contact a FUJIFILM representative.

■ **The following may be punishable by law:**

- Disassembly or modification of this device.
- Removal of device certification labels.

■ **Trademark Information**

The Bluetooth® word mark and logos are registered trademarks owned by the Bluetooth SIG, Inc., and any use of such marks by FUJIFILM is under license.

Information for traceability in Europe

Manufacturer: FUJIFILM Corporation

7-3, Akasaka 9-Chome, Minato-ku, Tokyo
Japan

Authorized representative in Europe:

FUJIFILM Europe GmbH

Balcke-Duerr-Allee 6, 40882 Ratingen
Germany

EU Importer : FUJIFILM Europe B.V.

Oudenstaart 1, 5047 TK Tilburg
The Netherlands
product.safety.eu@fujifilm.com

UK Importer : FUJIFILM UK Ltd.

Fujifilm House, Whitbread Way,
Bedford, Bedfordshire, MK42 0ZE
UK

If you have any inquiries about this product, please contact a FUJIFILM authorized dealer, or access the website below:
<https://www.fujifilm.com/>

FUJIFILM, instax, and instax mini Evo Cinema are registered trademarks or trademarks of FUJIFILM Corporation and its affiliates.

Independent JPEG Group (IJG) Licenses

This software is based in part on the work of the Independent JPEG Group.

© 2026 FUJIFILM Corporation. All rights reserved.



Statement of Compliance

2025-PSTI-006-E

Manufacturer:	FUJIFILM Corporation
Address:	7-3, Akasaka 9-Chome Minato-Ku, Tokyo 107-0052, JAPAN
UK Authorized Representative:	FUJIFILM UK Ltd.
Address:	Fujifilm House, Whitbread Way, Bedford, Bedfordshire, MK42 0ZE, United Kingdom
Trade Mark:	FUJIFILM
Product Name:	HYBRID INSTANT CAMERA
Product Model Number:	FI041
Model Number:	instax mini Evo Cinema
Support period:	<u>5 years after sales end</u> For details, refer to the website shown below. https://instax.co.uk/psti/

We, Fujifilm Corporation, herewith declare under our sole responsibility that the product(s) identified in this declaration conforms to the applicable security requirements in Schedule 1 of the following Regulations and Standards.

Regulations:	The Product Security and Telecommunications Infrastructure (Security Requirements for Relevant Connectable Products) Regulations 2023
Standards:	ETSI EN 303 645 V2.1.1 (2020-06) (provision 5.1-1, 5.1-2, 5.2-1, 5.3-13)
Place: JAPAN	(Signature) <i>A. Kobayashi</i>
Date: December 16, 2025	(Name, Function) Akihiro Kobayashi General Manager of Quality Assurance Group, Imaging Solutions Division FUJIFILM Corporation

FUJIFILM

FUJIFILM Corporation

7-3, AKASAKA 9-CHOME, MINATO-KU, TOKYO 107-0052, JAPAN